

Large Format Cores



Specifications

MBS cylinders are designed, engineered and manufactured to OEM specifications. This is something we do not compromise on. As a result you can have the utmost confidence that when keying into a system you will maintain the integrity of the system. Our cylinders will have the exact depth and spacing as originals.

Keying

MBS offers a wide array of keying options. Cylinders are usually stocked keyed alike in pairs. We also offer keyed random and zero bitted cylinders in a wide array of products. Please note that our zero bitted cylinders are actually cut to a 1 bit or 2 bit depending on keyway. The cylinders are packaged with uncut keys to be used when pinning the cylinder. MBS also offers Master Keying, Grand Master Keying, Construction Keying and numerous other options. Please contact us for details.

Table of Contents

3.....	Large Format IC Cores
6.....	Large Format IC Rim Cylinders
9.....	Large Format IC Mortise Cylinders
13.....	Mortise Thumb Turn Cylinders
15.....	Mortise Dummy Cylinders
17.....	Conventional Keyed Rim Cylinders
19.....	Conventional Keyed Mortise Cylinders
21.....	Knob/Lever Cylinders

Out of an abundance of caution, MBS has elected to place the Proposition 65 warning on all products shipped to California.



WARNING: These products can expose you to chemicals including chromium, which is known to the State of California to cause cancer and birth defects or other reproductive harm. For more information go to www.P65Warnings.ca.gov.

Large Format IC Core

- ▶ Solid brass construction
- ▶ Replaces Schlage large format IC core
- ▶ Available in 6-pin only
- ▶ Three finishes: satin chrome, satin brass and flat black coated
- ▶ 6 popular keyways



Model #	Type
7501	Large Format Interchangeable Core

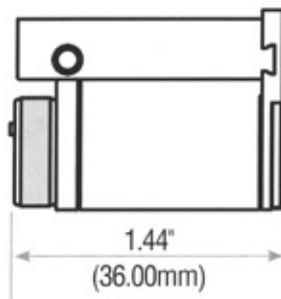
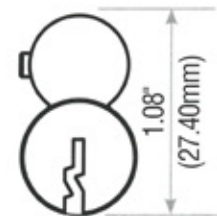

LFIC CORE

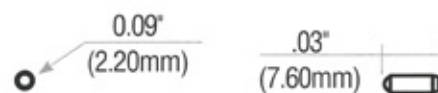

RPIN-02
Retaining Pin



LFIC CORE Schematic Drawing

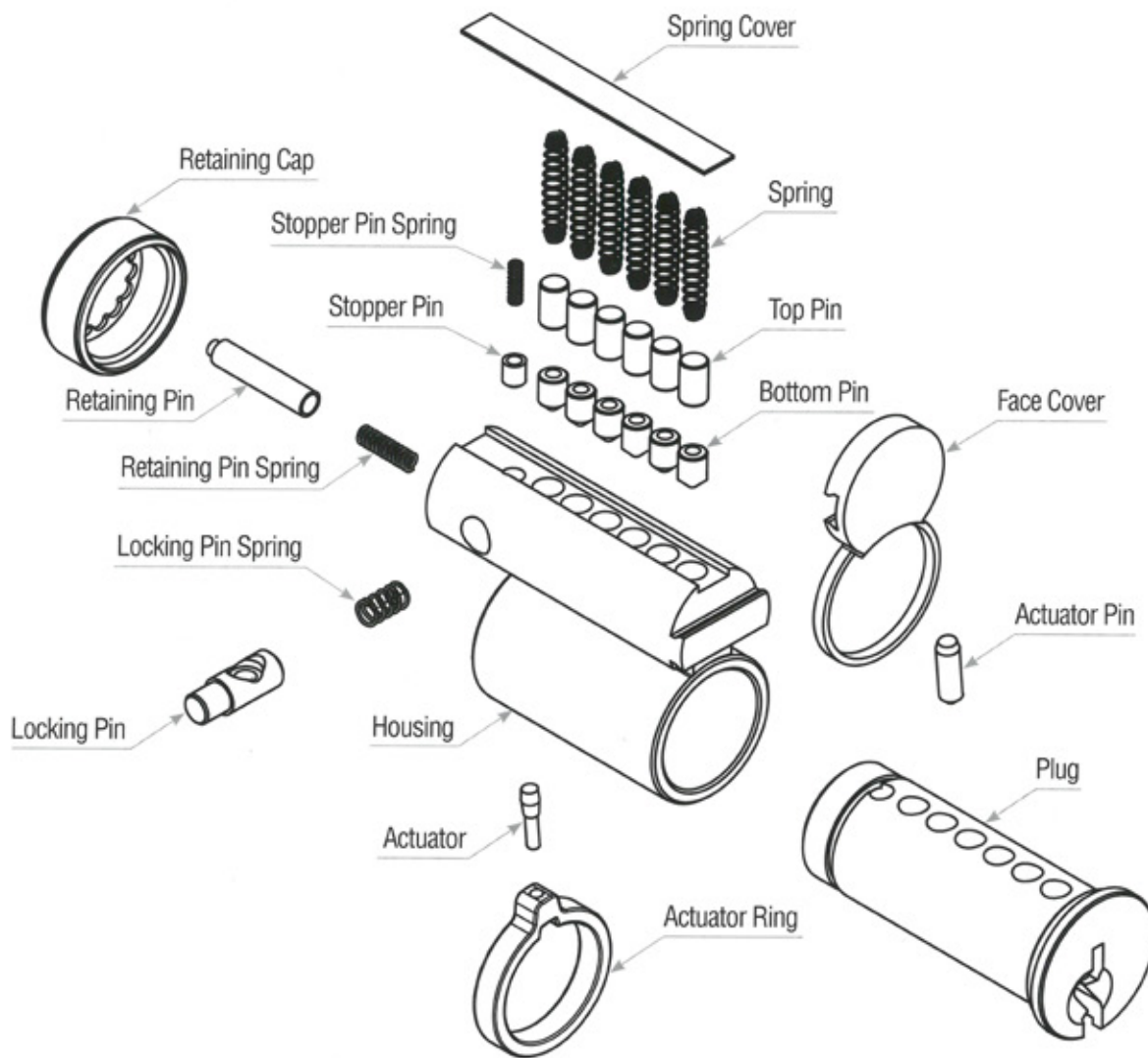

LFIC Keyways



Schlage C
SCC



Schlage C123
G23



Schlage C145
G45



Schlage C~K
SX



Schlage E
SCE



Schlage F
SCF

How to Order LFIC Cores

Model #	Keyway	Finish	Keying
7501	Schlage C Schlage E Schlage F Schlage 123 Schlage 145 Schlage C-K	Satin Brass Flat Black Coated Satin Chrome	Zero-Bitted Special Keying
	SCC SCE SCF G23* G45* SX	606 622 626	OB SK
7501	SCE	626	OB

*No keys are available for G23 and G45 Keyways due to patent restrictions.

LFIC Keys

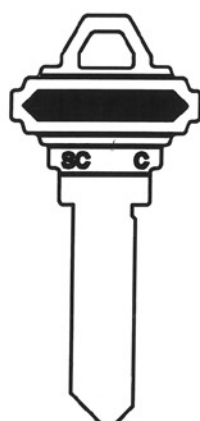

Schlage C
SCC

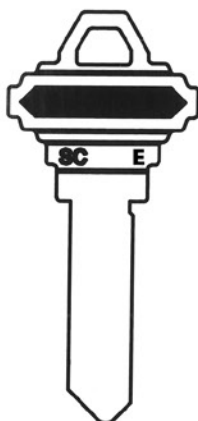

Schlage E
SCE



Schlage F
SCF

How to Order LFIC Keys

Model #	Length	Keyway	Cut
KB	6	SCC SCE SCF	1-Uncut (Box of 50) 2-Cut (single cut key)
KB	6	SCE	1

*No keys are available for G23 and G45 Keyways due to patent restrictions.



Large Format IC Rim Cylinder

- ▶ ICSR is compatible with Schlage large format IC cores
- ▶ Furnished with collar, mounting plate & screws
- ▶ Tailpiece converts between horizontal & vertical positions
- ▶ Solid brass construction

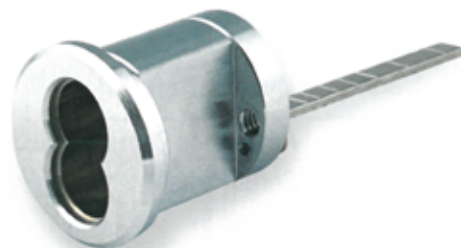

Model #	Type
MBS-ICSR	Schlage Large Rim Cylinder

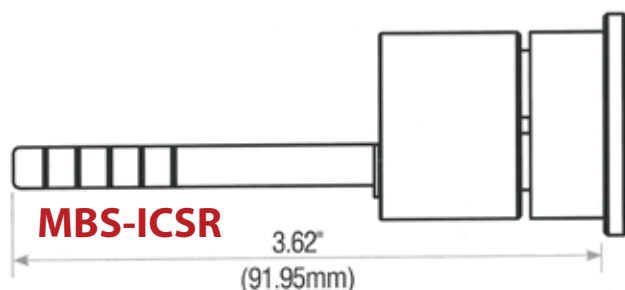
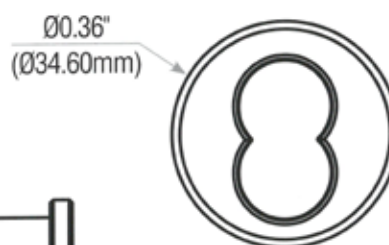

LFIC Rim Cylinder Schematic Drawing

MBS-ICSR

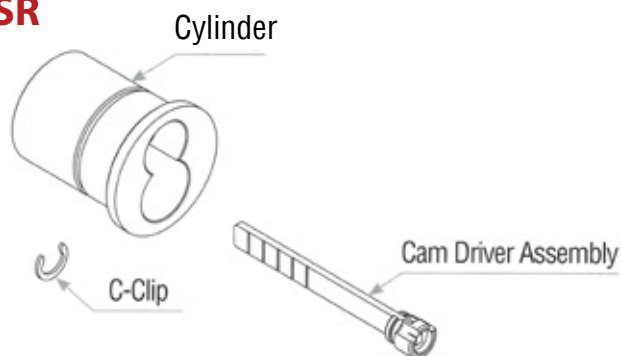

How to Order LFIC Rim Cylinders

LFIC Rim Cylinder **Model #**
MBS-ICSR

	Finish
Polished Brass	605
Satin Brass	606
Satin Bronze	612
Oil Rubbed Bronze	613
Satin Nickel	619
Flat Black Coated	622
Polished Chrome	625
Satin Chrome	626

MBS-ICSR

606

Rim Dummy Cylinders

- ▶ Non-hollow solid brass housing
- ▶ Furnished with collar, mounting plate & screws



Model #	Type	Length
MBS-R118D	Rim Dummy Cylinder	1-1/8" length

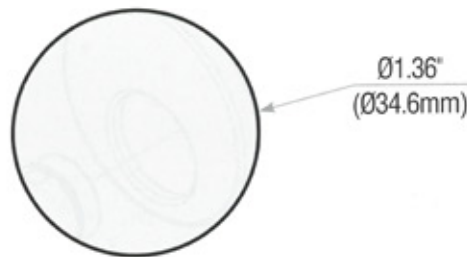

MBS-R118D

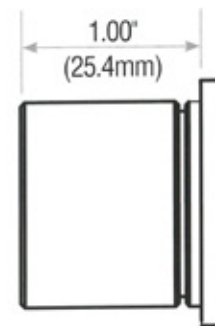

How to Order Rim Dummy Cylinders

1-1/8" Rim Dummy **Model #**
MBS-R118D

	Finish
Polished Brass	605
Satin Brass	606
Satin Bronze	612
Oil Rubbed Bronze	613
Satin Nickel	619
Flat Black Coated	622
Polished Chrome	625
Stainless Steel	630

MBS-R118D

606

Rim Cylinder Accessories

MPT-1

Mounting Plate

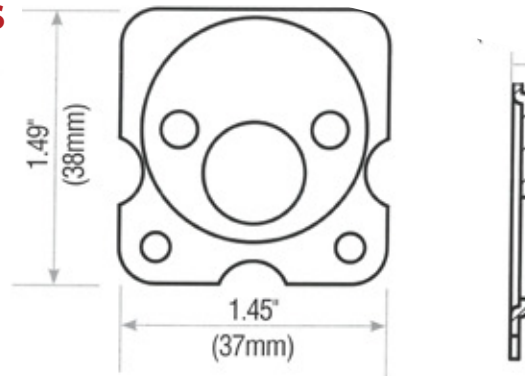

TLP-04

Standard Breakoff
Tailpiece

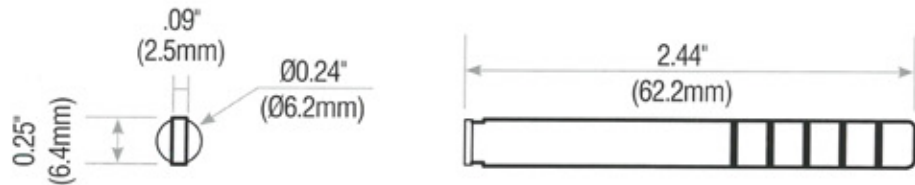

SCR-2

Standard Breakoff
Retaining Screws

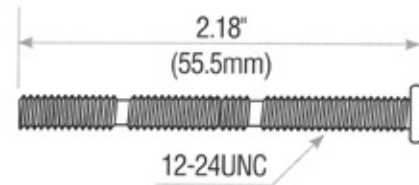

CAP-60

Retaining Cap

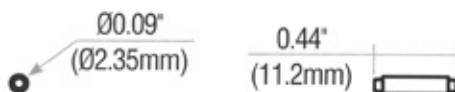
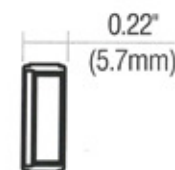
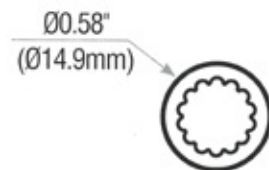

RPIN-01

Retaining Pin



SPR-6

Retaining Pin Spring

Large Format IC Mortise Cylinder

- ▶ Compatible with original Large Format IC cores
- ▶ Interchangeable cams
- ▶ Solid brass construction
- ▶ 7 popular cams available



Model #	Type
MBS-CCM	Corbin LFIC Mortise Cylinder, Straight
MBS-ICS	Schlage LFIC Mortise Cylinder, Straight
MBS-SCM	Sargent LFIC Mortise Cylinder, Straight
MBS-YCM	Yale LFIC Mortise Cylinder, Straight

See page 12 for cams.

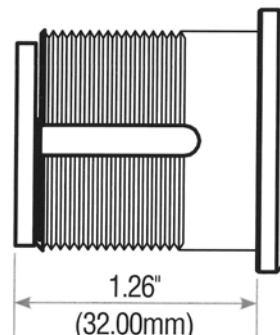
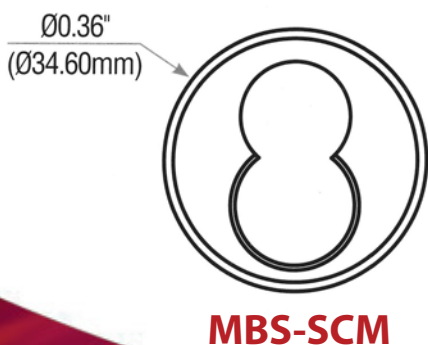
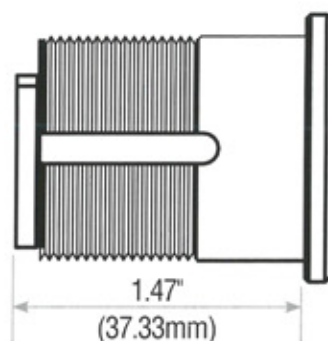
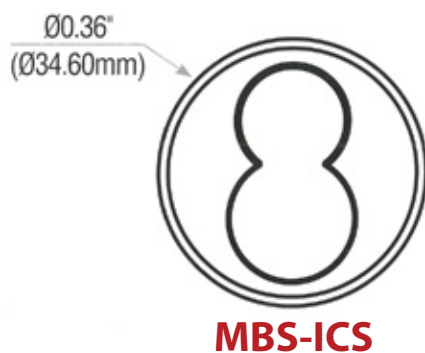
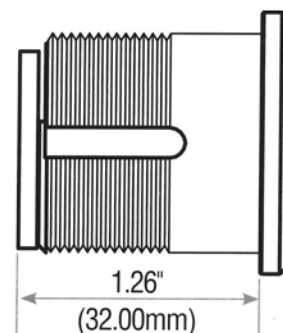
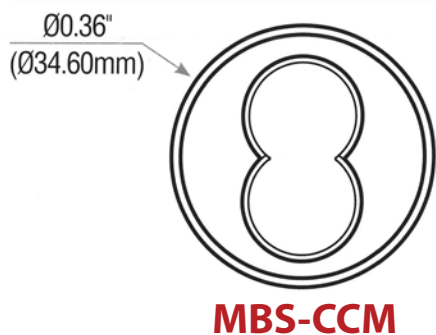

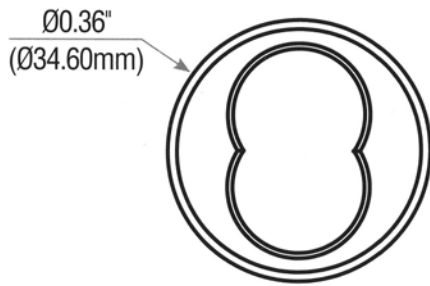

MBS-YCM

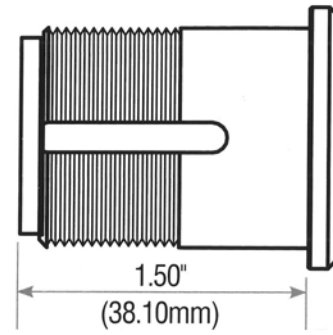

SCR-5



LFIC Mortise Cylinder Schematic Drawings

MBS-CCM

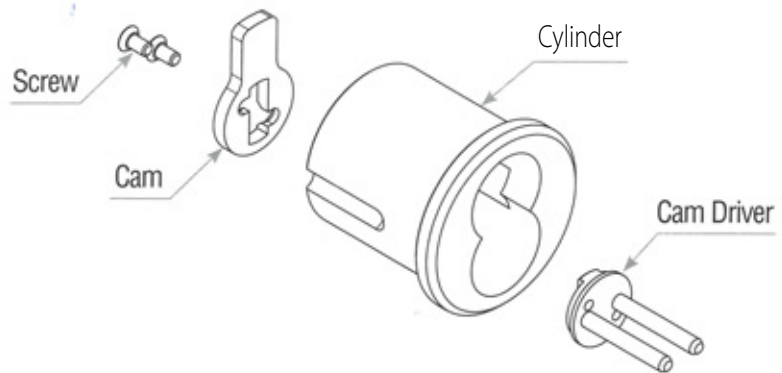

MBS-ICS

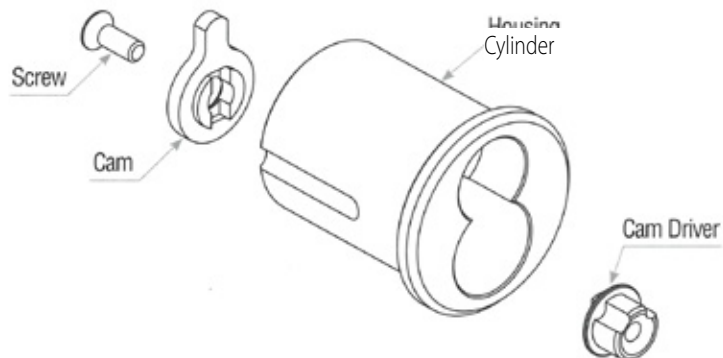

MBS-SCM

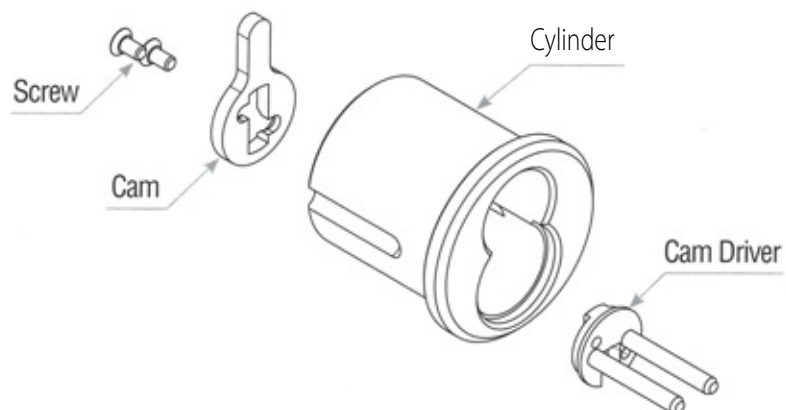

MBS-YCM

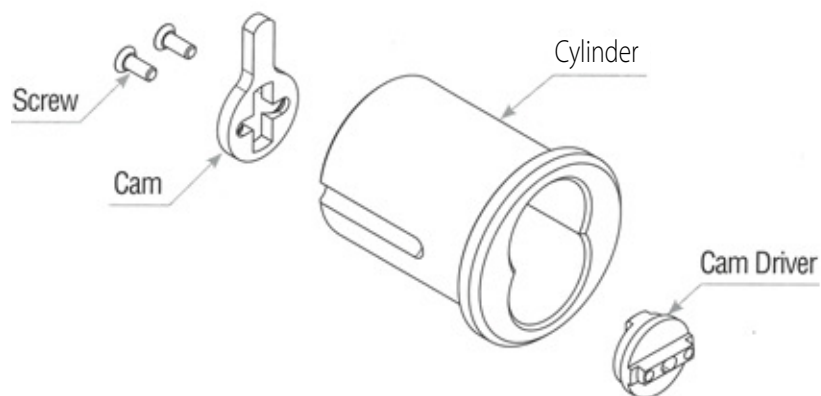

How to Order LFIC Mortise Cylinders

		Finish		Cam	
	Model #				
Corbin LFIC Mortise Cylinder, Straight	MBS-CCM	Polished Brass	605	Almet	1 AL
Schlage LFIC Mortise Cylinder, Straight	MBS-ICS	Satin Brass	606	Adams Rite	2 or 3 AR
Sargent LFIC Mortise Cylinder, Straight	MBS-SCM	Satin Bronze	612	Best	2 BE
Yale LFIC Mortise Cylinder, Straight	MBS-YCM	Oil Rubbed Bronze	613	Corbin	2 or 3 CL
		Satin Nickel	619	MBS/Falcon/Saflok	2 or 3 MB
		Flat Black Coated	622	Sargent	2 or 3 SA
		Polished Chrome	625	Schlage	2 or 3 SL
		Satin Chrome	626	Yale	2 or 3 ST

MBS-ICS

626

CAM3-MB



Cams for MBS-ICS Large Format IC Cylinders

The cams shown below are actual size.

Cam #	Description
CAM3-AR	AdamsRite Cam
CAM3-CL	Corbin Cam
CAM3-MB	MBS/Falcon/Saflok Cam
CAM3-SA	Sargent Cam
CAM3-SL	Schlage Cam
CAM3-ST	Yale Cam

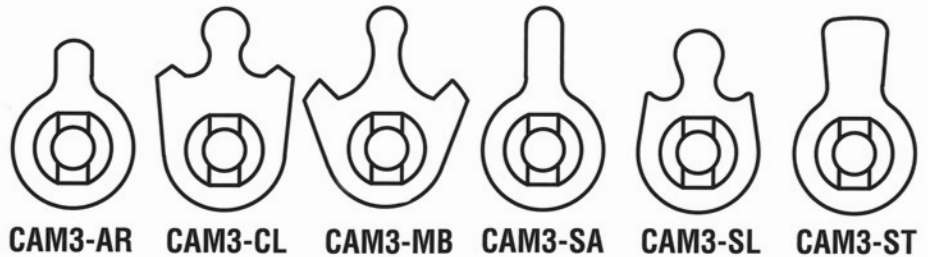

Cams for MBS-CCM and MBS-SCM Large Format IC Cylinders

The cams shown below are actual size.

Cam #	Description
CAM2-AR	AdamsRite Cam
CAM2-BE	Best Cam
CAM2-CL	Corbin Cam
CAM2-MB	MBS/Falcon/Saflok Cam
CAM2-SA	Sargent Cam
CAM2-SL	Schlage Cam
CAM2-ST	Yale Cam

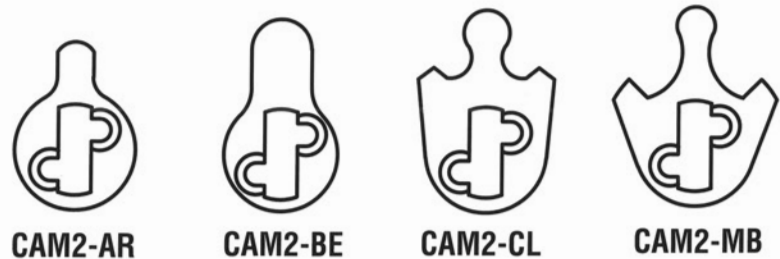

Cam for MBS-YCM Large Format IC Cylinders

Cam #	Description
CAM1-AL	Almet Cam



Mortise Thumb-Turn Cylinders

- ▶ Solid brass construction
- ▶ 3 popular lengths
- ▶ 8 popular cams
- ▶ Ergonomic turn knob provides easy turning
- ▶ Available in eight finishes

Model #	Type	Length
MBS-M100T	Mortise Thumb-Turn Cylinder	1" length
MBS-M118T	Mortise Thumb-Turn Cylinder	1-1/8" length
MBS-M114T	Mortise Thumb-Turn Cylinder	1-1/4" length
MBS-M100TA	ADA Mortise Thumb-Turn Cylinder	1" length
MBS-M118TA	ADA Mortise Thumb-Turn Cylinder	1-1/8" length
MBS-M114TA	ADA Mortise Thumb-Turn Cylinder	1-1/4" length



ADA Thumb-Turn Cylinder

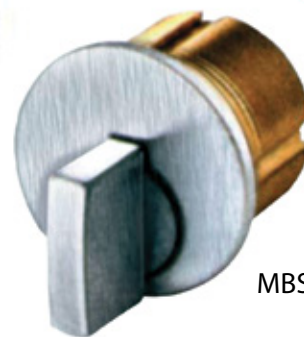

MBS-M100T



MBS-M114T

MBS-M118T

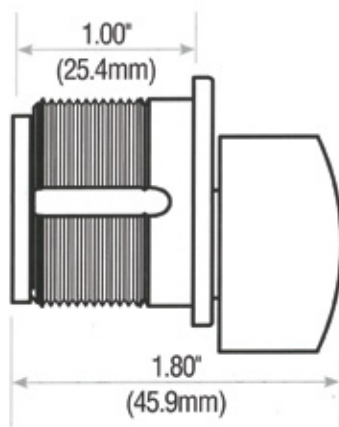

MBS-M100T

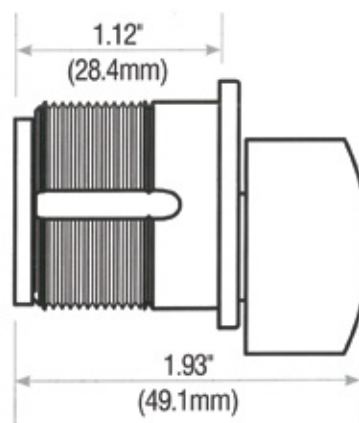

MBS-M118T

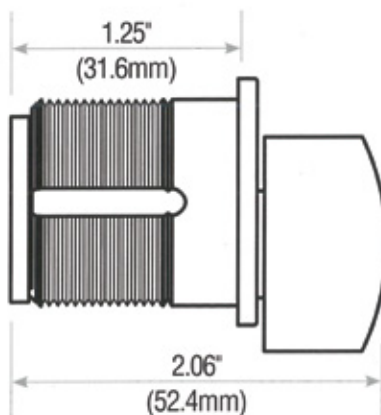
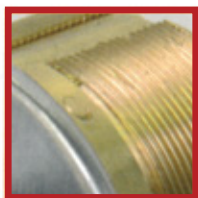

MBS-M114T

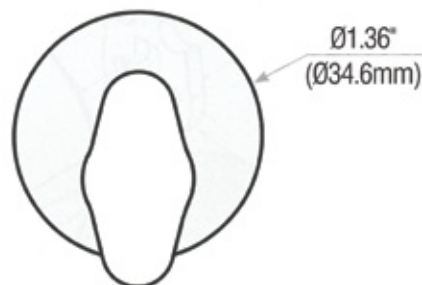



Mortise Thumb-Turn Cylinder Schematic Drawing

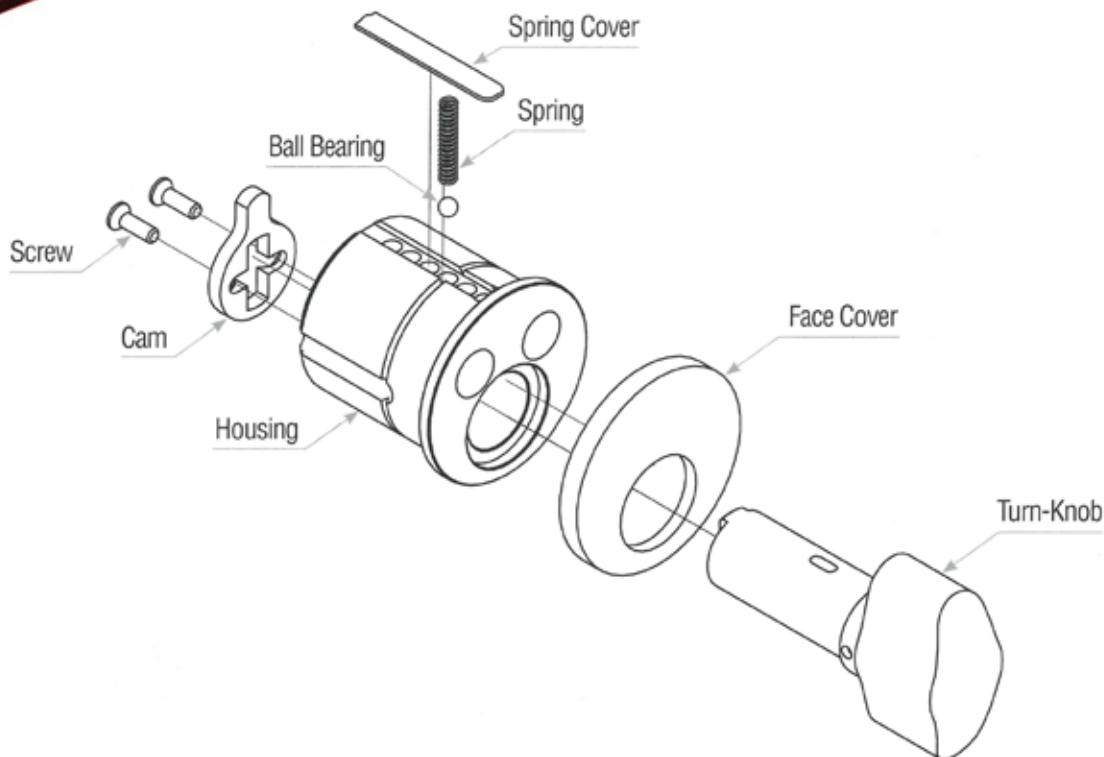

Cams for Mortise Thumb-Turn Cylinders

The cams shown below are actual size. Locktite is used in combination with the mortise screws to provide exceptional holding of the cam to the cylinder plug.

Cam #	Description
CAM1-AL	Almet Cam
CAM1-AR	AdamsRite Cam
CAM1-BE	Best Cam
CAM1-CL	Corbin Cam
CAM1-MB	MBS/Falcon/Saflok Cam
CAM1-SA	Sargent Cam
CAM1-SL	Schlage Cam
CAM1-ST	Yale Cam



CAM1-AL



CAM1-AR



CAM1-BE



CAM1-CL



CAM1-MB



CAM1-SA



CAM1-SL



CAM1-ST

Mortise Cylinder Cam Screw

These screws fit all MBS mortise cylinders.



SCR1

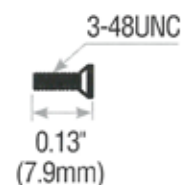

Mortise Dummy Cylinders

- ▶ Non-hollow solid brass construction
- ▶ 4 popular lengths
- ▶ Exact threads
- ▶ Available in eight finishes



Model #	Type	Length
MBS-M156D	Mortise Dummy Cylinder	15.16" length
MBS-M100D	Mortise Dummy Cylinder	1" length
MBS-M118D	Mortise Dummy Cylinder	1-1/8" length
MBS-M114D	Mortise Dummy Cylinder	1-1/4" length

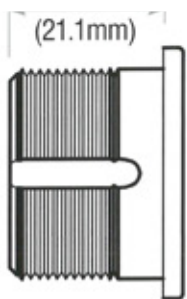
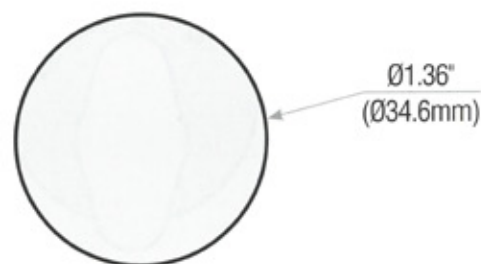

MBS-M156D

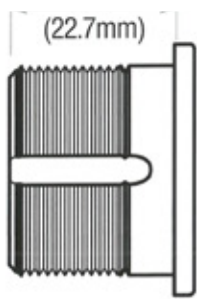

MBS-M100D

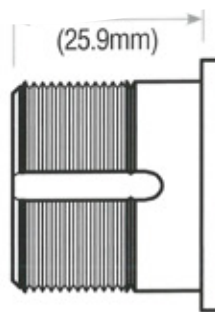

MBS-M118D

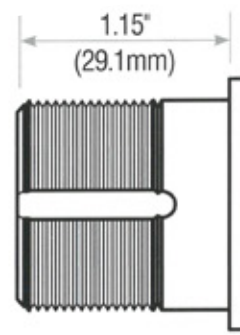

MBS-M114D

How to Order Mortise Dummy and Thumb Turn Cylinders

	Model #		Finish		Cam
15/16" Mortise Dummy	MBS-156D	Polished Brass	605	Almet	CAM1-AL
1" Mortise Dummy	MBS-100D	Satin Brass	606	Adams Rite	CAM1-AR
1-1/8" Mortise Dummy	MBS-118D	Satin Bronze	612	Best	CAM1-BE
1-1/4" Mortise Dummy	MBS-114D	Oil Rubbed Bronze	613	Corbin	CAM1-CL
15/16" Mortise Thumb-Turn	MBS-156T	Satin Nickel	619	MBS/Falcon/Saflok	CAM1-MB
1" Mortise Thumb-Turn	MBS-100T	Flat Black Coated	622	Sargent	CAM1-SA
1-1/8" Mortise Thumb-Turn	MBS-118T	Polished Chrome	625	Schlage	CAM1-SL
1-1/4" Mortise Thumb-Turn	MBS-114T	Satin Chrome	626	Yale	CAM1-ST
1" Mortise Thumb-Turn	MBS-M100TA	Stainless Steel	630		
1-1/8" Mortise Thumb-Turn	MBS-M118TA				
1-1/4" Mortise Thumb-Turn	MBS-M114TA				

MBS-156T

606

CAM1-MB



Collars and Rings for Mortise Cylinders

All MBS collars fit standard mortise cylinders and mortise thumb-turn cylinders. Collars are available in 605, 613 and 626 finish only.

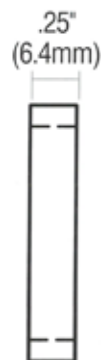
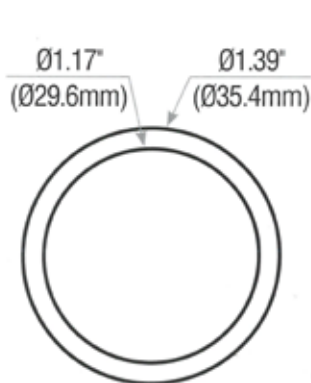
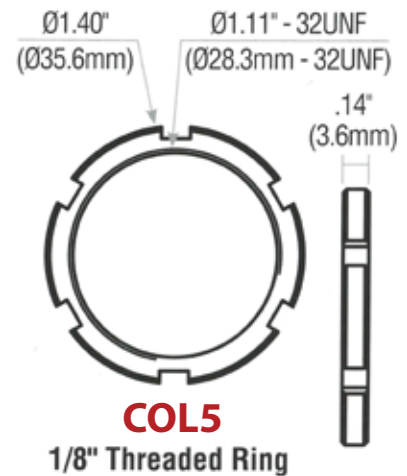
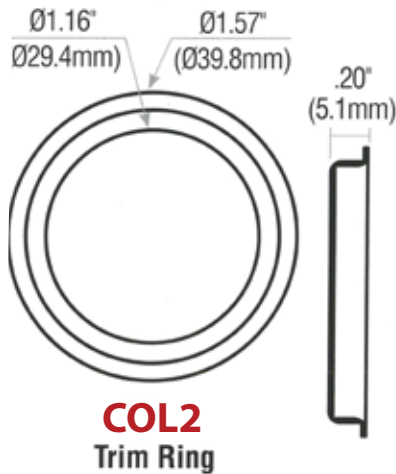

TR200A - Trim Ring Package

- Three trim rings packaged together as a set
- Includes TR201 (1/8"), TR202 (1/4") and TR203 (3/8") trim
- Available in 605, 613 or 630 finish



Includes TR201, TR202 and TR203

Also available individually

TR201- 1/8" thickness

- 1/8" trim ring
- Available in 605, 613, or 630 finish

TR202 - 1/4" thickness

- 1/4" trim ring
- Available in 605, 613, or 630 finish

TR203 - 3/8" thickness

- 3/8" trim ring
- Available in 605, 613, or 630 finish

Conventional Keyed Rim Cylinders

- ▶ Exact pinning specifications as original systems
- ▶ Solid brass construction
- ▶ 19 keyways
- ▶ Tailpiece converts between horizontal & vertical position
- ▶ Screw-on retaining cap design
- ▶ 5 pin drilled 6 and 6 pin cylinders

Model #	Type	Length
MBS-R118	Rim Cylinder	1-1/8" length

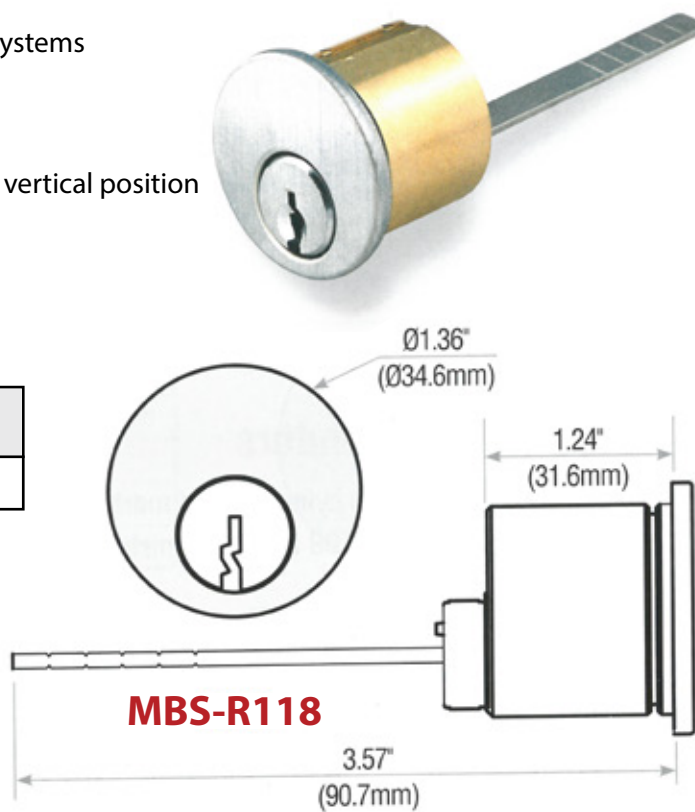

How to Order Keyed Rim Cylinders

		Keyway							
1-1/8" Rim	Model # MBS-R118	Arrow 1176	AW						
		Corbin 60	CB						
		Corbin L4	CL4						
		Kwikset 1179	KW						
		Russwin D1	RD1						
		Sargent LA	SA						
		Sargent LA-LD	SAX						
		Sargent LB	SLB						
		Sargent RA	RA						
		Schlage C	SCC						
		Schlage C123	G23*						
		Schlage C145	G45*						
		Schlage C-K	SX						
		Schlage E	SCE						
		Schlage F	SCF						
		Segal 9	SE						
		Weiser E	WR						
		Yale 8	YA						
		Yale GA	YGA						
		Finish				Keying			
		Polished Brass	605	Keyed alike		KA5			
		Satin Brass	606	in pairs		KA6			
		Satin Bronze	612	Zero		OB5			
		Oil Rubbed Bronze	613	bitted		OB6			
		Satin Nickel	619	Keyed		KD5			
		Flat Black Coated	622	different		KD6			
		Polished Chrome	625	Special		SK5			
		Satin Chrome	626	Keying		SK6			
		Stainles Steel	630						
MBS-R118		SCE		626		KA6			

No keys are available for G23 and G45 Keyways due to patent restrictions.

To order Keys for Conventional Keyed Rim Cylinders, see page 27.



Keyed Rim Cylinder Schematic Drawing

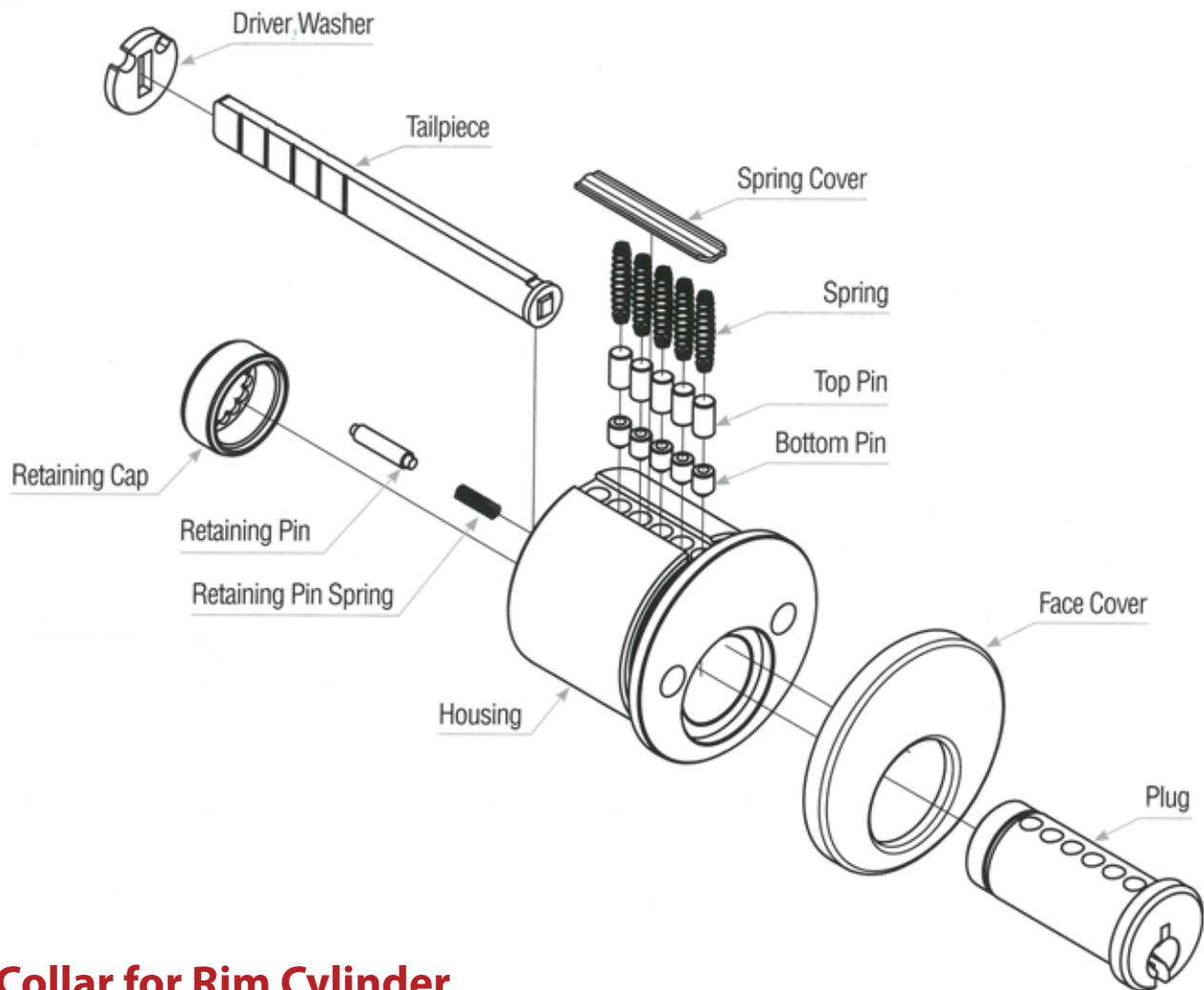

Collar for Rim Cylinder

Attractive collar finishes off any application.

Comes in polished brass (605), satin chrome (626) and oil rubbed bronze (613) finishes.

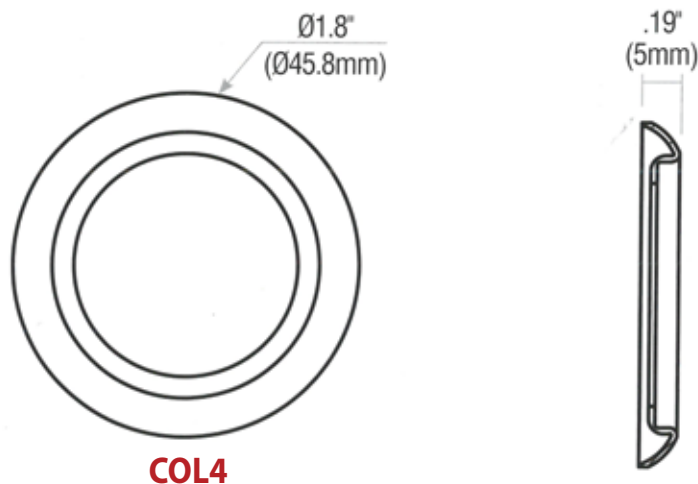

Conventional Keyed Mortise Cylinders

- ▶ Exact pinning specifications as original systems
- ▶ Solid brass construction
- ▶ 19 keyways
- ▶ 4 popular lengths
- ▶ 8 popular cams
- ▶ Available in nine finishes



Model #	Type	Length	Pins
M4501	Mortise Cylinder	15/16" length	5 Pin
M4502	Mortise Cylinder	1" length	5 Pin
M4503	Mortise Cylinder	1-1/8" length	5 Pin Drilled 6 or 6 Pin
M4504	Mortise Cylinder	1-1/4" length	5 Pin Drilled 6 or 6 Pin

Custom lengths available, call for details.

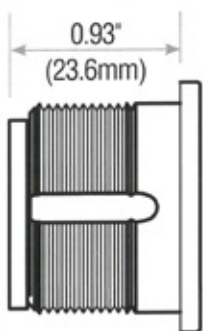
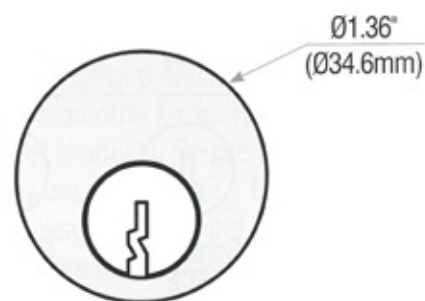

M4501

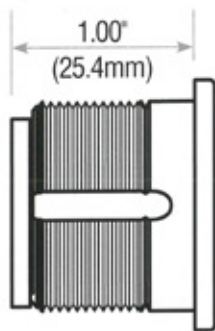

M4502

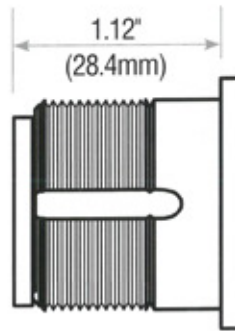

M4503

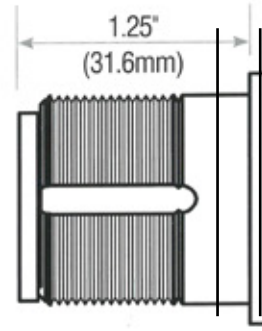

M4504

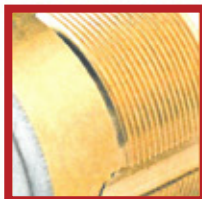

Keyed Mortise Cylinder Schematic Drawing

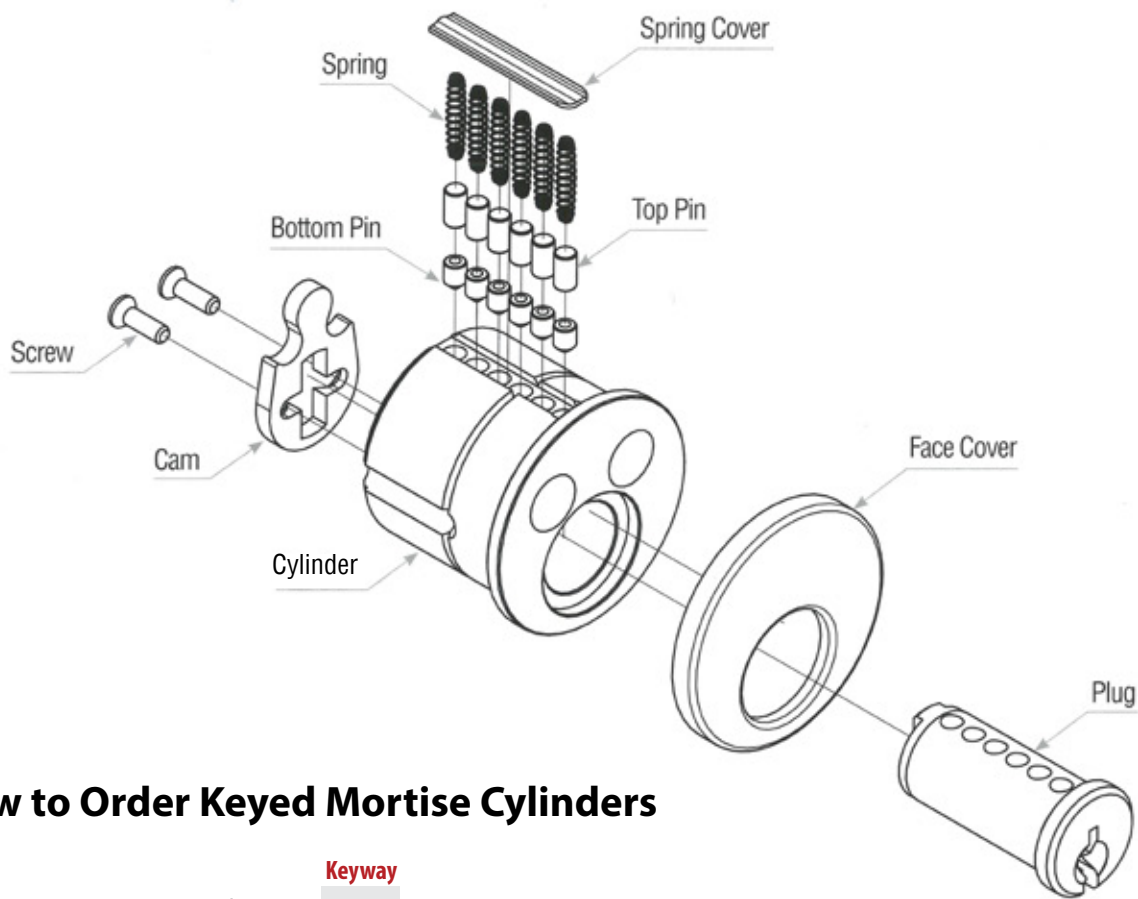

How to Order Keyed Mortise Cylinders

		Keyway							
		Arrow 1176	AW						
		Corbin 60	CB						
		Corbin L4	CL4						
		Kwikset 1179	KW						
		Russwin D1	RD1						
		Sargent LA	SA						
		Sargent LA-LD	SAX						
		Sargent LB	SLB						
		Sargent RA	RA						
		Schlage C	SCC						
		Schlage C123	G23*						
		Schlage C145	G45*						
		Schlage C-K	SX						
		Schlage E	SCE						
		Schlage F	SCF						
		Segal 9	SE						
		Weiser E	WR						
		Yale 8	YA						
		Yale GA	YGA						
				Finish		See cam illustrations on Page 14		Keying	
				Polished Brass		Cam		Keyed alike	
				Satin Brass		AL		in pairs	
				Satin Bronze		AR		Zero	
				Oil Rubbed Bronze		BE		bitted	
				Satin Nickel		CL		Keyed	
				Flat Black Coated		MB		different	
				Polished Chrome		A		Special	
				Satin Chrome		SL		Keying	
				Stainless Steel		ST			

Knob/Lever Cylinders

- ▶ Exact pinning specifications as original systems
- ▶ Solid brass construction
- ▶ 19 keyways
- ▶ Available in 3 finishes
- ▶ Supplied with multiple tailpieces
- ▶ Screw-on retaining cap design (except K002)

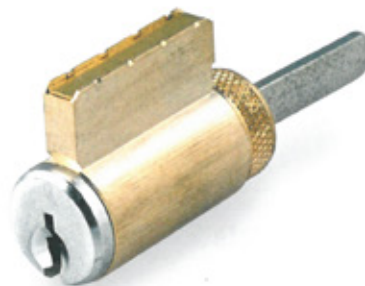

Model #	Type	Length	Tailpieces
K001	Knob/Lever Cylinder	Schlage knobs, levers, deadbolts and Yale levers*	5 tailpieces
K002	Knob/Lever Cylinder	Fits Arrow knobs and levers	3 tailpieces
K003	Knob/Lever Cylinder	Fits Sargent levers	3 tailpieces

*Converts to fit Yale levers with KIT-K001YA (page 25).

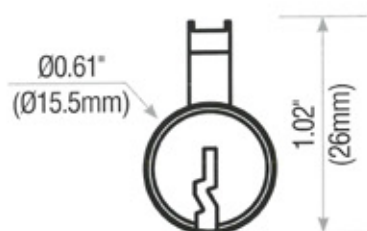

K001

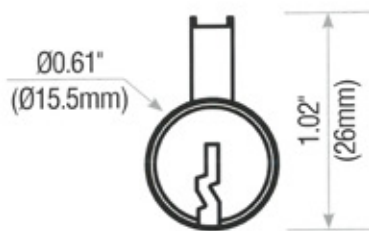

K002

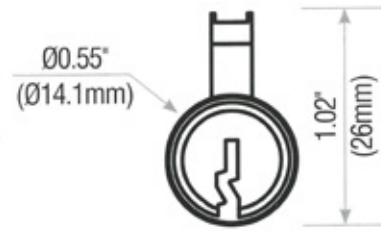

K003

Knob/Lever Cylinder Schematic Drawing

K001 & K003

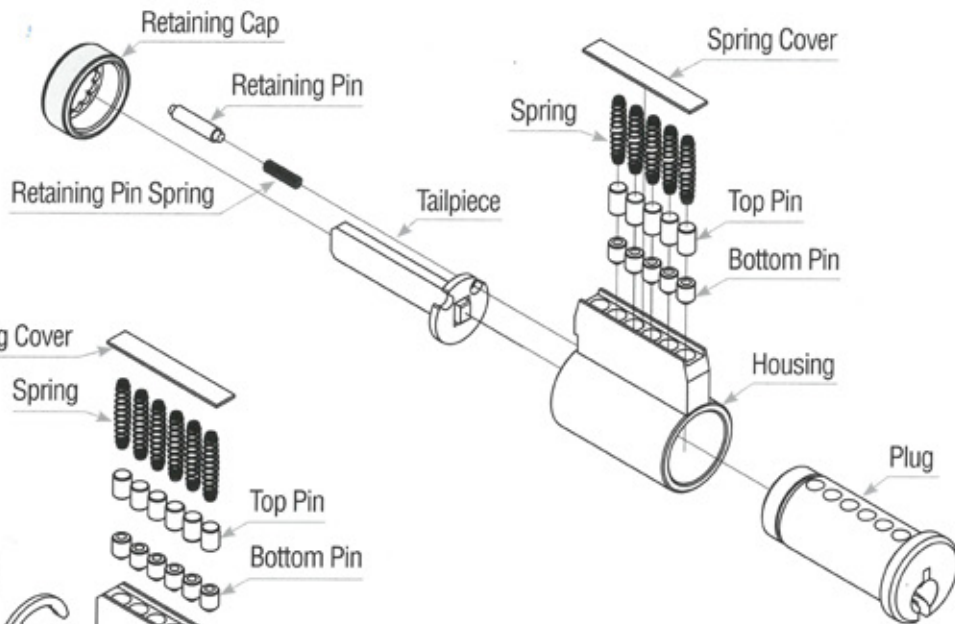

K002

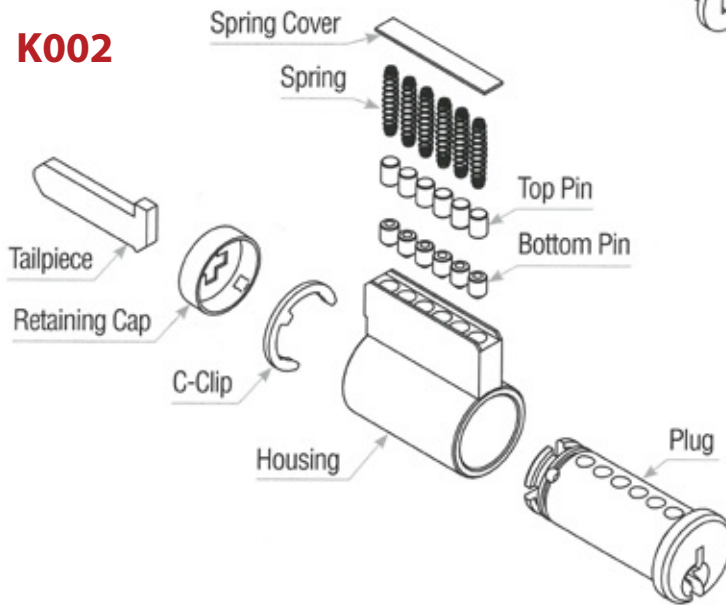

Standard Keyways for Knob/Lever Cylinders

MBS manufactures the keyways shown below as part of our standard offering. All of the keyways are designed to meet the OEM specification.



Arrow 1176
AW



Corbin 60
CB60



Corbin L4
CL4



Kwikset 1179
KW



Russwin D1
RD1



Sargent LA
SA



Sargent LA~LD
SAX



Sargent LB
SLB



Sargent RA
RA



Segal 9
SE



Weiser E
WR



Yale 8
YA



Yale GA
YGA



Schlage C
SCC



Schlage C123
G23



Schlage C145
G45



Schlage C~K
SX



Schlage E
SCE



Schlage F
SCF

How to Order Knob/Lever Cylinders

Keyway

Arrow 1176	AW
Corbin 60	CB
Corbin L4	CL4
Kwikset 1179	KW
Russwin D1	RD1
Sargent LA	SA
Sargent LA-LD	SAX
Sargent LB	SLB
Sargent RA	RA
Schlage C	SCC
Schlage C123	G23*
Schlage C145	G45*
Schlage C-K	SX
Schlage E	SCE
Schlage F	SCF
Segal 9	SE
Weiser E	WR
Yale 8	YA
Yale GA	YGA

Model

K001
K002
K003

Finish

Satin Brass	606
Flat Black Coated	622
Satin Chrome	626

Cam

Almet	AL
Adams Rite	AR
Adams Rite & Yale	AT
Best	BE
Corbin	CL
Sargent	SA
Schlage	SL
Yale	ST
MBS/Falcon/Saflok	MB

Keying

Keyed alike	KA5
in pairs	KA6
Zero	0B5
bitted	0B6
Keyed	KD5
different	KD6
Special	SK5
Keying	SK6

K001

SCE

626

CAM1-MB

KA6

*No keys are available for G23 and G45 Keyways due to patent restrictions. **Cylinders are 6 pin.

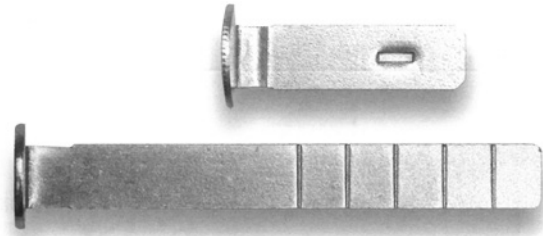

Tailpieces

MBS manufactures multiple tailpieces to accommodate different applications. All tailpieces are plated hardened steel for durability.

TLP-01

Tailpiece

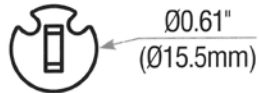

TLP-02

Tailpiece

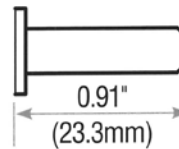
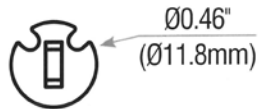

TLP-03

Tailpiece

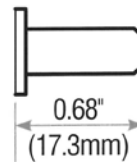
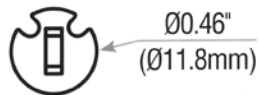

TLP-05

Breakoff
Tailpiece

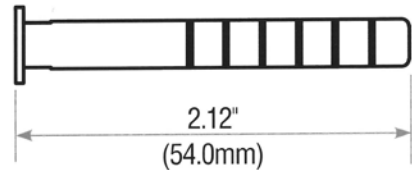
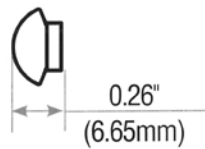

TLP-06

Tailpiece

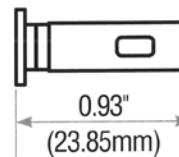
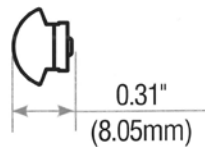

TLP-08

Tailpiece

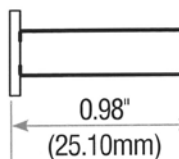
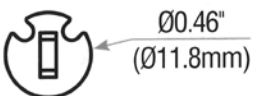

Knob/Lever Cylinder Accessories

TLP-WA

Washer

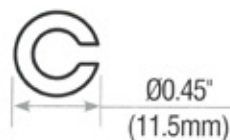

CAP-60

Retaining Cap

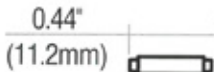
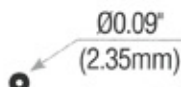
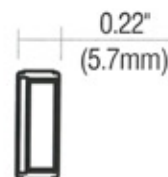
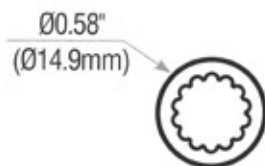

RPIN-01

Retaining Pin

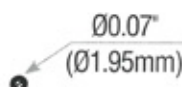

SPR-06

Retaining Pin Spring

KIT-K001YA

Yale Conversion Kit

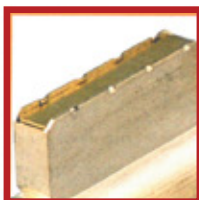
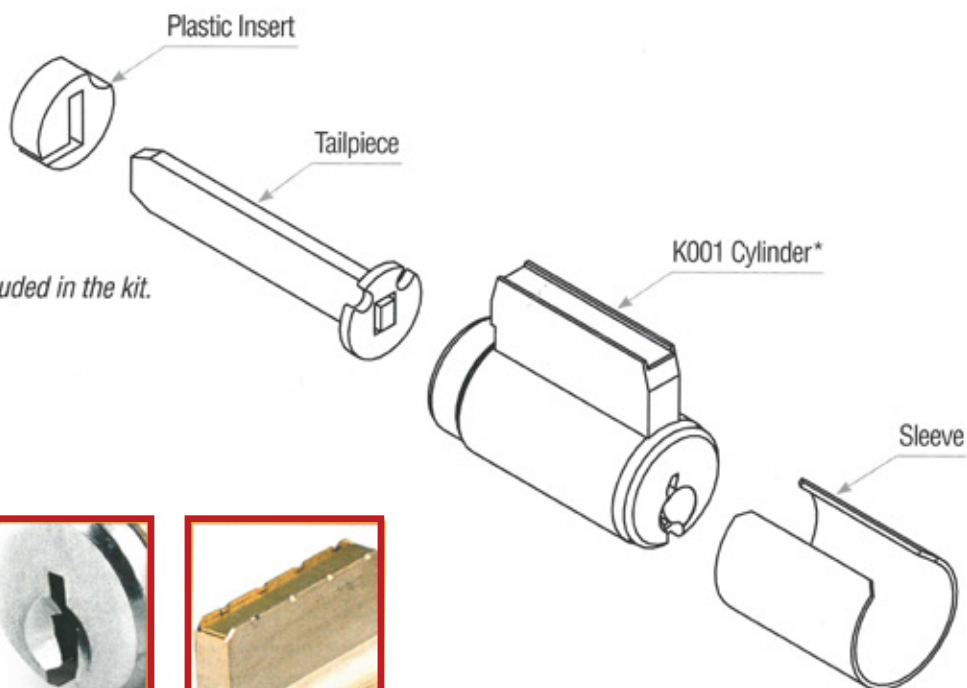

Key Blanks for Knob/Lever Cylinder

- ▶ Made of solid brass
- ▶ Keys bow design is same as originals
- ▶ Meet OEM specifications



Arrow
5AW
6AW

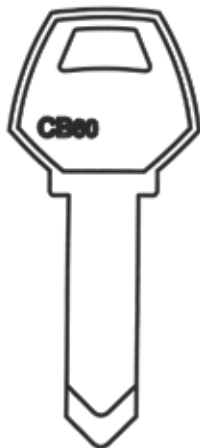

Corbin 60
5C60
6C60



Corbin L4
5CL4
6CL4



Kwikset
5KW
6KW



Russwin D1
5RD1
6RD1



Sargent LA
5SLA
6SLA



Sargent LB
5SLB
6SLB



Sargent RA
5SRA
6SRA



Schlage C
5SCC
6SCC



Schlage E
5SCE
6SCE

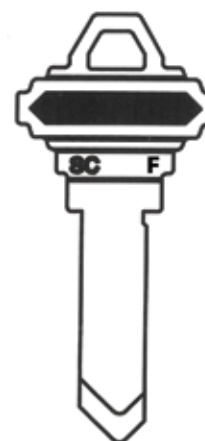

Schlage F
5SCF
6SCF



Segal 9
5S9
6S9

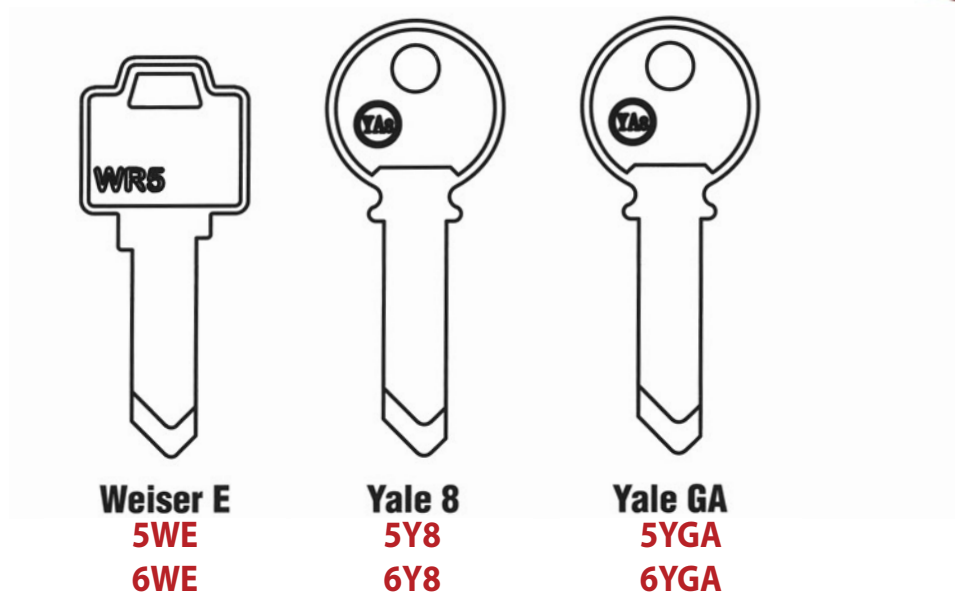

How to Order Keys for Conventional Keyed Rim and Mortise Cylinders and Knob/Lever Cylinders

Model #		Length		Keyway		Cut	
KB		5		AW		1-Uncut (Box of 50)	
KB		6		AW		2-Cut (single cut key)	
KB		5		AW		2	

*Uncut Keys are available in boxes of 50. Cut keys are available individually.



Marshall Best Security Corporation

www.MarshallBestSecurity

10005 Cumberland Pointe Blvd. • Noblesville, Indiana 46060

317-806-1180 • F: 317-578-2901