

MBS CORP. CLUTCHING MORTISE WITH ESCUTCHEON TRIM - ASSEMBLY INSTRUCTIONS

ITEM#	DESCRIPTION	QTY
1	CYLINDER (OPTIONAL)	1
2	CYLINDER SPRING (OPTIONAL)	1
3	CYLINDER COLLAR (OPTIONAL)	1
4	ESCUTCHEON D/S	1
5	LEVER ASSEMBLY (D/S LEFT)	1
6	SPINDLE, 1/2" (CLIP)	1
7	LEVER ASSEMBLY (D/S LEFT)	1
8	TRUMB TURN SPINDLE (OPTIONAL)	1
9	ESCUTCHEON 1/2"	1
10	ESCUTCHEON MOUNTING SCREWS	2
11	ASSEMBLY MOUNTING SCREW	1
12	SPINDLE, 1/2" (UNLOCKED)	1
13	FACE PLATE	2
14	MORTISE MOUNTING SCREW	2
15	MORTISE	2
16	PLATE	1
17	MOUNTING POST	1
18		2

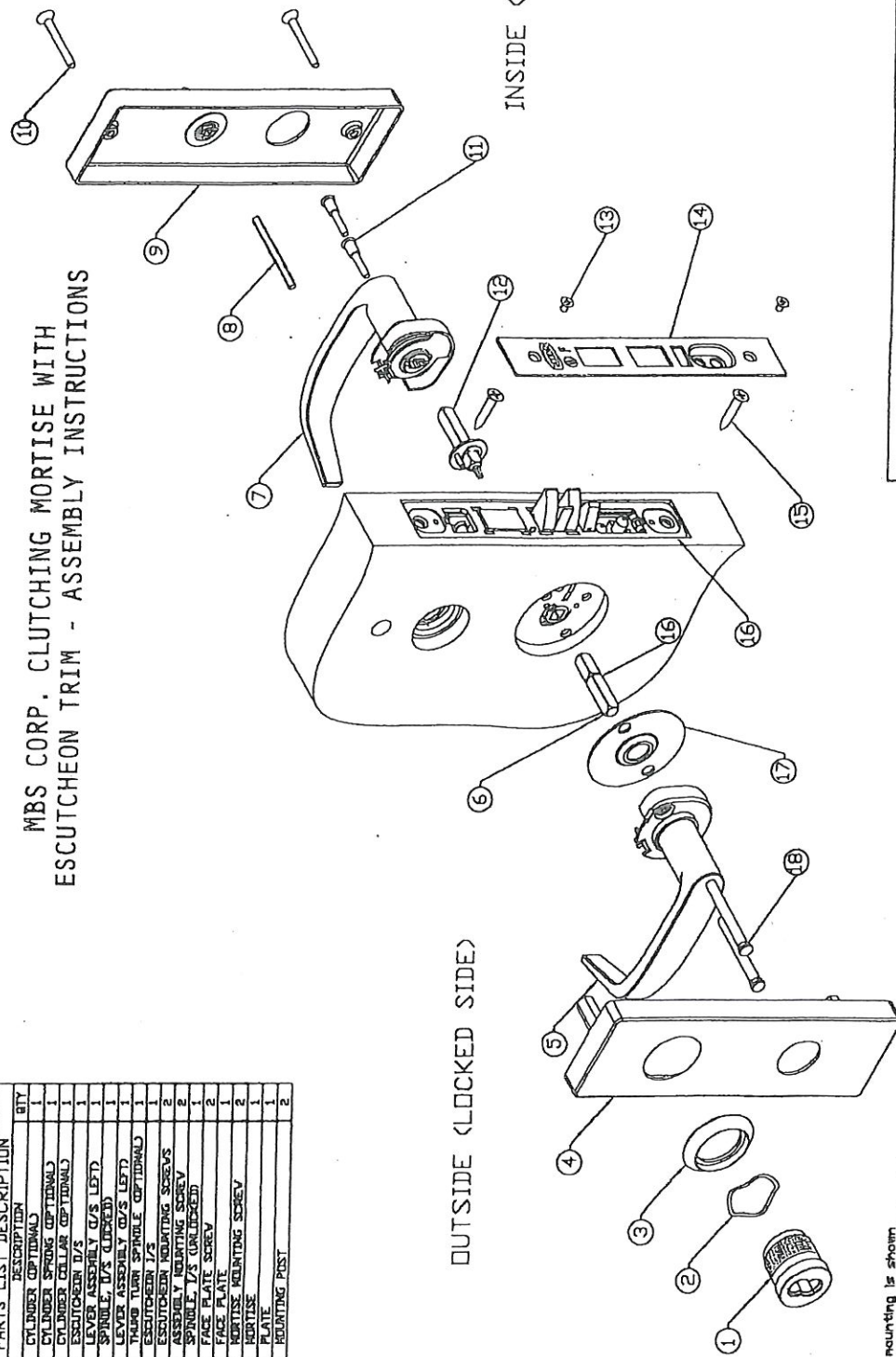

NOTE: LEFT HAND MOUNTING IS SHOWN

- Prepare door with fastener template
- Insert mortise (item 1) into hole
- Insert inside and outside pins (item 6 & 12) into the lock case hub and tighten screw
- Insert 2 mounting posts (item 18) into the door
- Position outside (D/S) lever assembly onto the mortise - pin up spindle
- Position inside (D/S) lever assembly (item 7) onto the mortise - pin up spindle
- Using the 2 mounting screws (item 10) fasten the 1/2" lever assembly.
- Position thumb turn spindle (item 8), if required, as shown between escutcheon and mortise
- Optional - screw in cylinder (item 1) using spring and collar (items 2 & 3)
- Fasten cylinder to operational depth and secure with mortise set screw
- Fasten escutcheon (item 14) on using screws (item 10)
- LOCK SET PRIOR TO LOCKING/SHUTTING DOOR
- ALWAYS CHECK OPERATION

TO CHANGE HANDING: REVERSE INSIDE & OUTSIDE LEVER ASSEMBLIES (Items 5 & 7)

MBS
MARSHALL BEST SECURITY CORP.
 13097 Parkside Dr., Suite B
 Fishers, IN 46038 • 317-806-1180
 www.marshallbestsecurity.com

DRAFT UNLESS OTHERWISE SPECIFIED 1" MAX DRAWN BY: SC DATE: 3-6-14	A TELEDIMENSIONS UNLESS OTHERWISE SPECIFIED XX RESTRICTED DIMENSIONS XXX RESTRICTED DIMENSIONS FRACTIONS - 1/32 ANGLES - 1/2° DIMENSIONS SURFACES KEY (Symbol) THIRD ANGLE	MATERIAL NOTED HEAT TREAT: N/A FINISH: N/A TITLE: CLUTCHING MORTISE ASSEMBLY INSTRUCTION PARTS INSTRUCTION
--	---	--

THIS DRAWING AND THE INFORMATION CONTAINED THEREIN OR DERIVED THEREFROM ARE THE CONFIDENTIAL PROPERTY OF MARSHALL BEST SECURITY CORP. IT IS NOT TO BE REPRODUCED OR DISCLOSED TO OTHERS, AND MAY BE USED ONLY FOR THE PURPOSE OF ENABLING THE PARTY TO WHOM IT HAS BEEN LOANED TO COMPLETE OR FILL AN ORDER FOR MARSHALL BEST SECURITY CORP., OR AS MAY BE OTHERWISE AUTHORIZED BY MARSHALL BEST SECURITY CORP. IN WRITING.