

**1400/F1400 SERIES
MORTISE LOCK EXIT DEVICE**

INSTALLATION INSTRUCTIONS

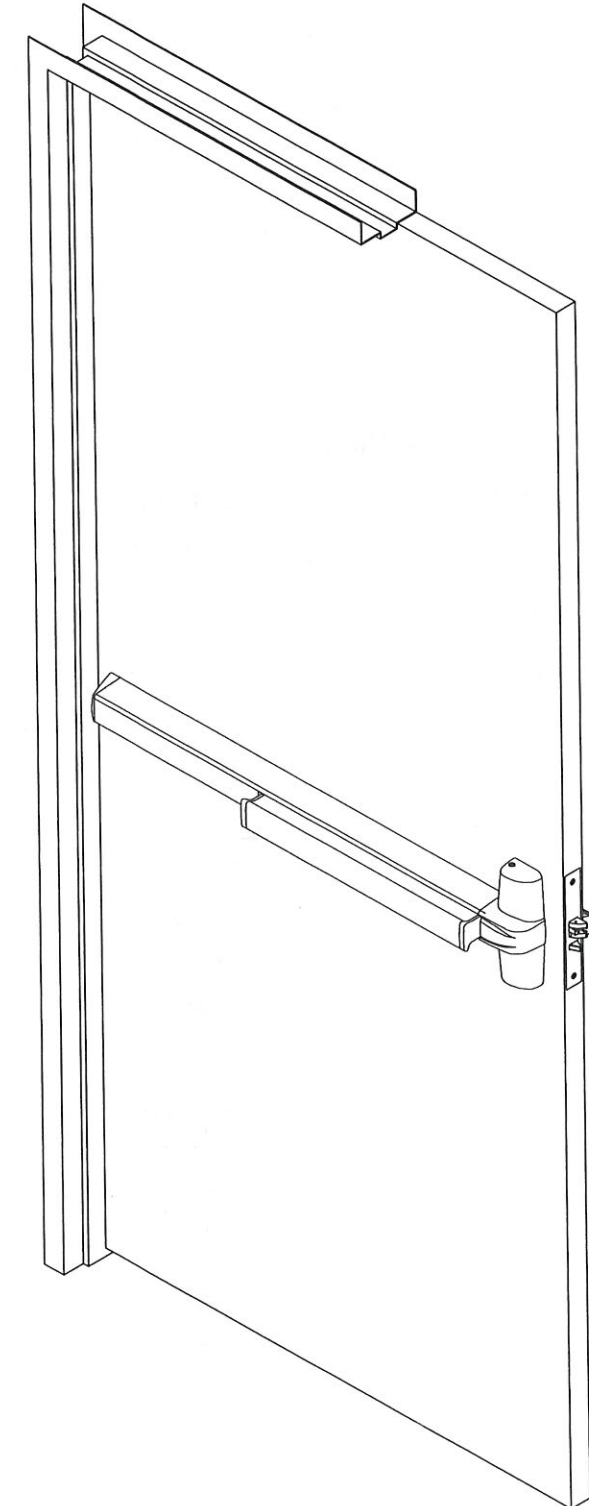

Patent No. 7,634,927 7,748,757
D623,499 7,836,738 7,887,107
and other patents pending.

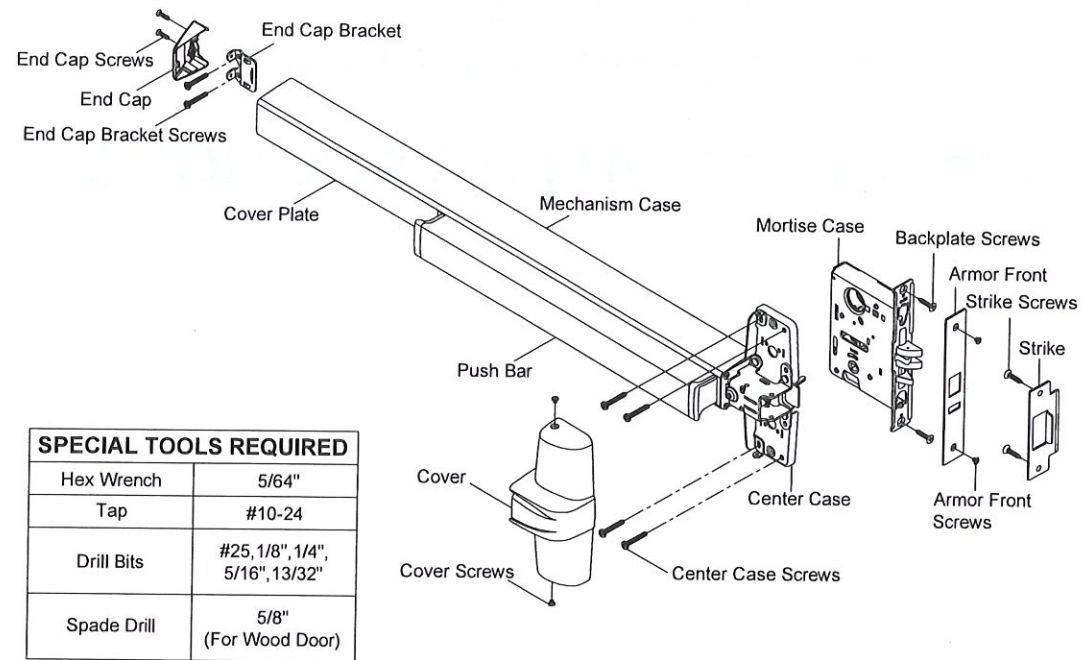

SPECIAL TOOLS REQUIRED	
Hex Wrench	5/64"
Tap	#10-24
Drill Bits	#25, 1/8", 1/4", 5/16", 13/32"
Spade Drill	5/8" (For Wood Door)

SCREW CHART

APPLICATION	METAL	SEX BOLTS	WOOD
 Center Case Screws	 No.10-24 x 1-11/32" 4 PCS	 No.10-24 x 1-3/32" 4 PCS	 No.10-12 x 1-11/32" 4 PCS
 End Cap Bracket Screws	 No.10-24 x 1-11/32" 2 PCS	 No.10-24 x 1-3/32" 2 PCS	 No.10-12 x 1-11/32" 2 PCS
 End Cap Screws		 No.8-32 x 5/8" 2 PCS	
 Cover Screws		 No.8-32 x 5/32" 2 PCS	
 Cylinder Screws		 No.10-24 x 1-11/32" 2 PCS	
 Backplate Screws		 No.12-24 x 7/8" 2 PCS	
 Armor Front Screws		 No.8-32 x 5/32" 2 PCS	
 306 / 336 / 337 / 338 Strike Screws		 No.12-24 x 7/8" 2 PCS	

SECURITY INDICATOR KIT INSTALLATION

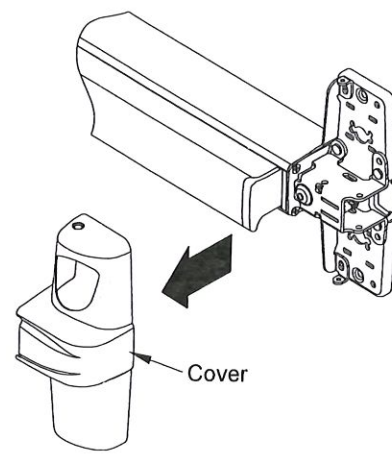

1. Remove cover.

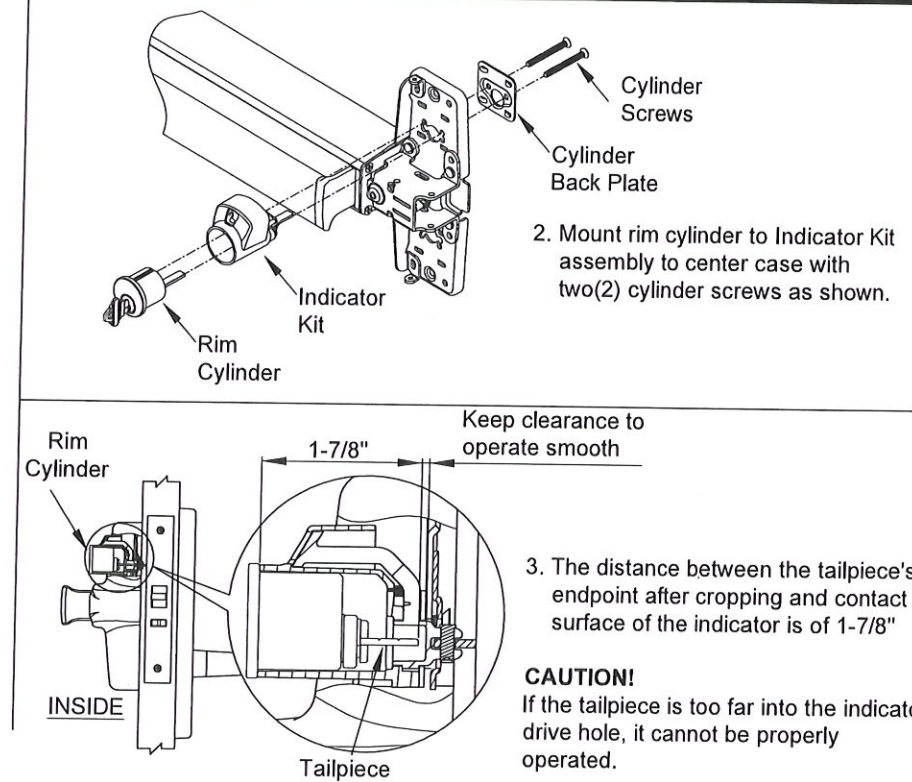

2. Mount rim cylinder to Indicator Kit assembly to center case with two(2) cylinder screws as shown.

3. The distance between the tailpiece's endpoint after cropping and contact surface of the indicator is of 1-7/8"

CAUTION!
If the tailpiece is too far into the indicator drive hole, it cannot be properly operated.

CUT DEVICE (IF REQUIRED)

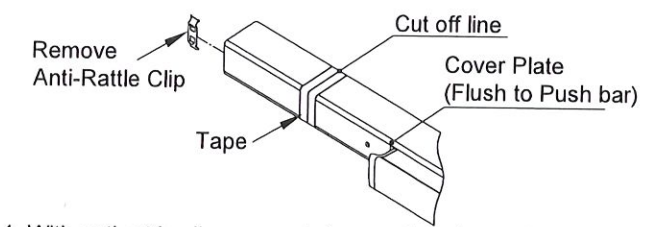
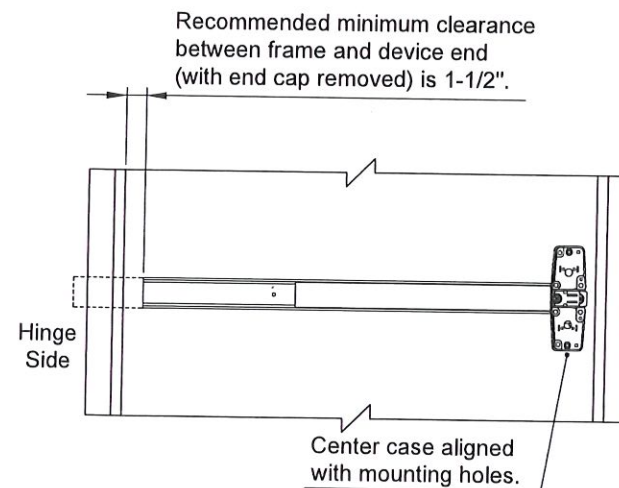

1. With anti-rattle clip removed, tape and mark area being cut.

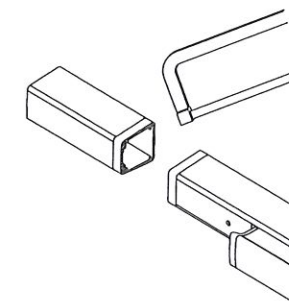

2. Cut off device and deburr.
NOTE: Device must be cut square for proper end cap fit.



9 ADJUSTING LATCH BOLT.

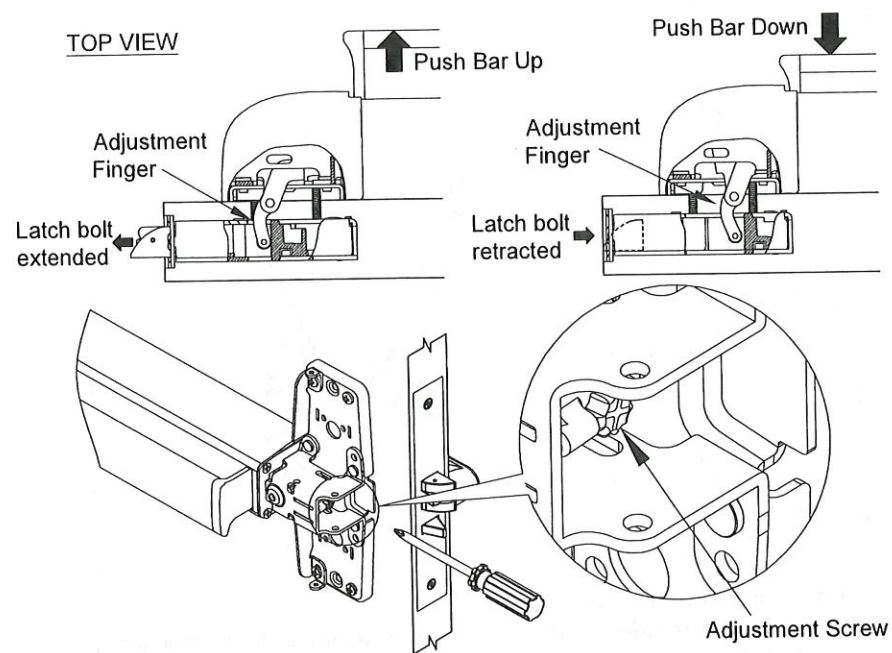

Latchbolt should be fully retracted when push bar is depressed or device is dogged down. If above condition does not exist, adjust "adjustment finger" with adjusting "adjustment screw".

10 INSTALL CASE COVER.

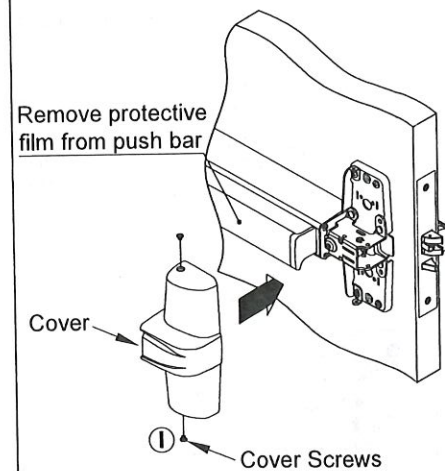

Attach cover to center case with two(2) center case screws.

DOOR PREPARATION CHART

RHR shown (LHR opposite)

CENTER CASE - 4 HOLES	
SURFACE MOUNT	SEX BOLTS OR TRIM
METAL	METAL
#25 DRILL #10-24 TAP	1/4" DRILL (DEVICE SIDE) 13/32" DRILL (TRIM SIDE)
WOOD	WOOD
1/8" DRILL PILOT 1" DEEP	13/32" DRILL THRU

END CAP BRKT. - 2 HOLES	
SURFACE MOUNT	SEX BOLTS
METAL	METAL
#25 DRILL #10-24 TAP	1/4" DRILL (DEVICE SIDE) 13/32" DRILL (TRIM SIDE)
WOOD	WOOD
1/8" DRILL PILOT 1" DEEP	13/32" DRILL THRU

*PREPARE HOLES AFTER LOCK SIDE OF DEVICE IS MOUNTED AND HINGE SIDE OF DEVICE IS LEVELED

OPTIONAL DOGGING

CYLINDER DOGGING

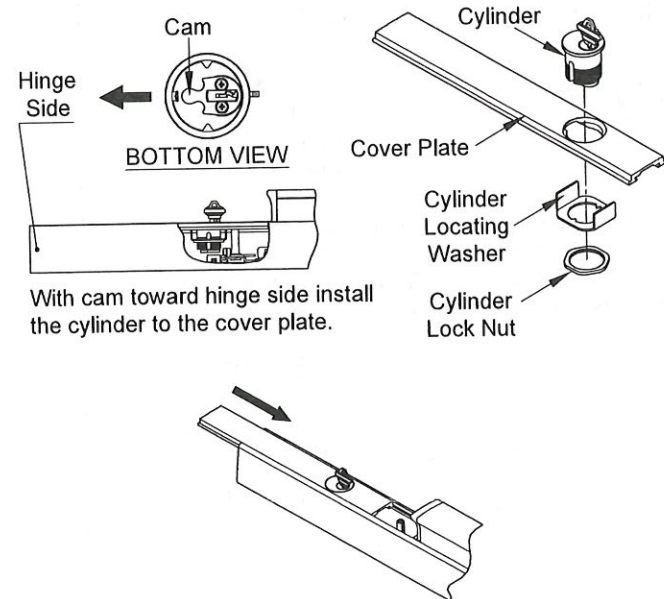

Slide cover plate in position in the mechanism case.

DOGGING CHECK

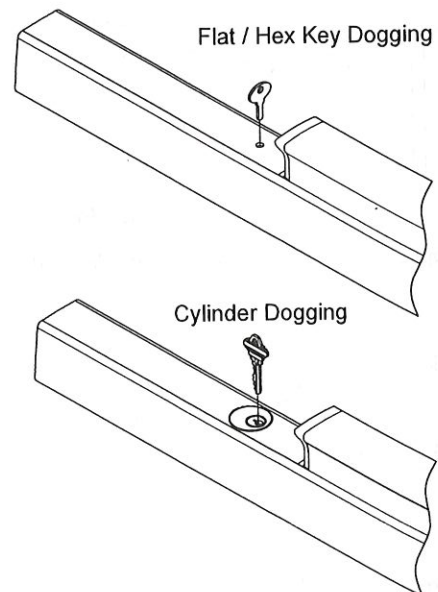

Depress push bar and turn flat / hex wrench or key one full turn for dogging check.

STRIKE PREPARATION

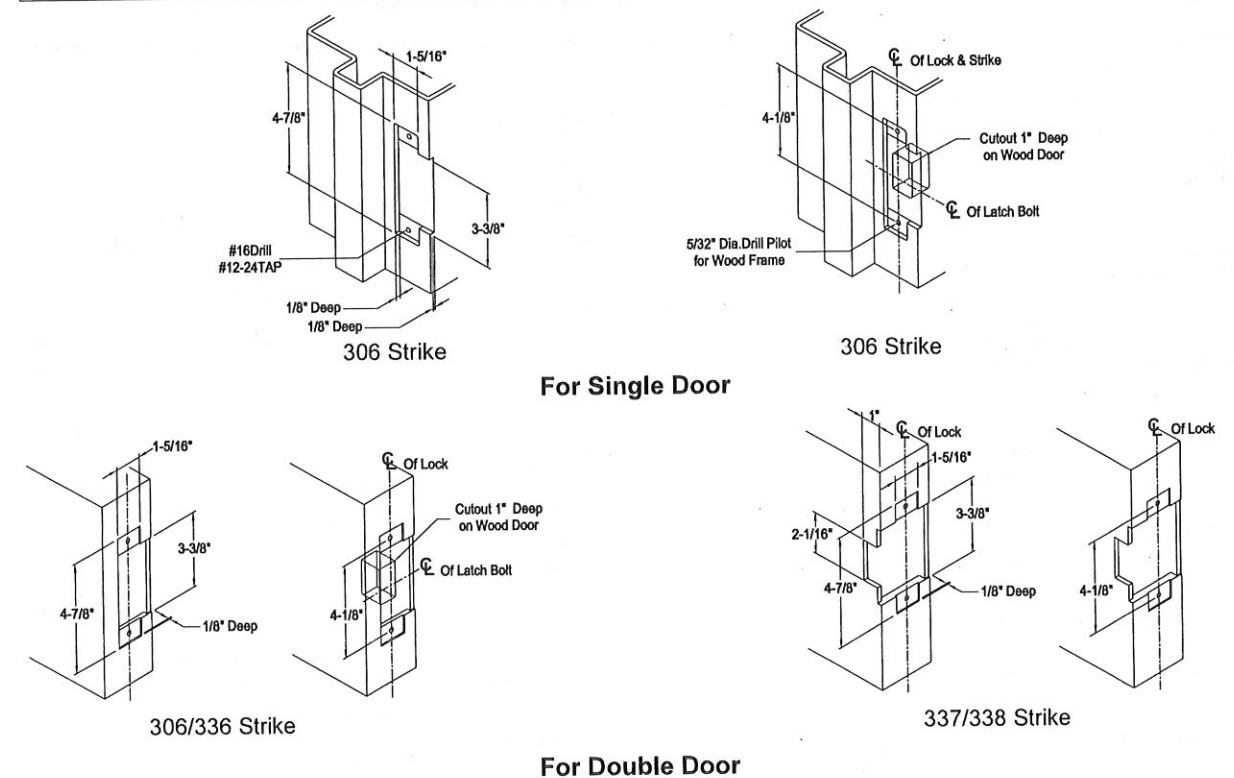

1 DRAW HORIZONTAL DEVICE CENTERLINE (☉).

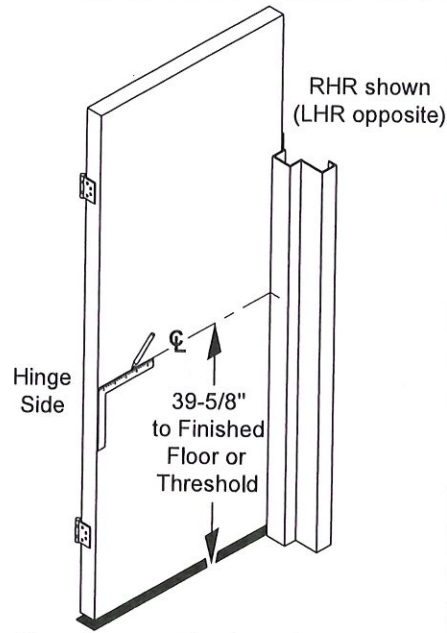

Close door, mark horizontal centerline on inside face of door and on lock side door stop 39-5/8" from finish floor as shown, (Continue horizontal centerline to outside face of door if trim is used)

2 ALIGN TEMPLATE ALONG CENTERLINE (☉) AND MARK DOOR.

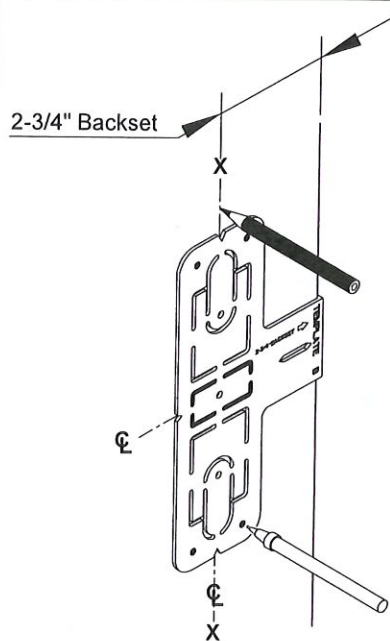

Mark four(4) center case holes. Mark vertical centerline at lock side using 2-3/4" backset dimension.

3 PREPARE FOUR(4) CENTER CASE HOLES AND MORTISE LOCK CUTOUTS.

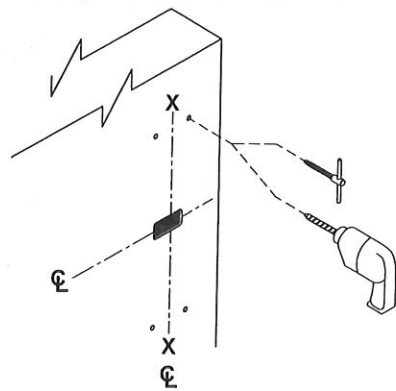

3A. Mark vertical centerline at lock side using 2-3/4" backset dimension (If trim is using mark vertical centerline on the outside face of door. Use extra care if edge of door is beveled, be sure X-X vertical centerline is parallel to edge of door).
3B. If door is not pre-machined for mortise lock, mortise the door according to "Mortise Lock Instructions".

See "Trim Instructions" for pull side door preparation.

4 INSTALL MORTISE LOCK INTO DOOR.

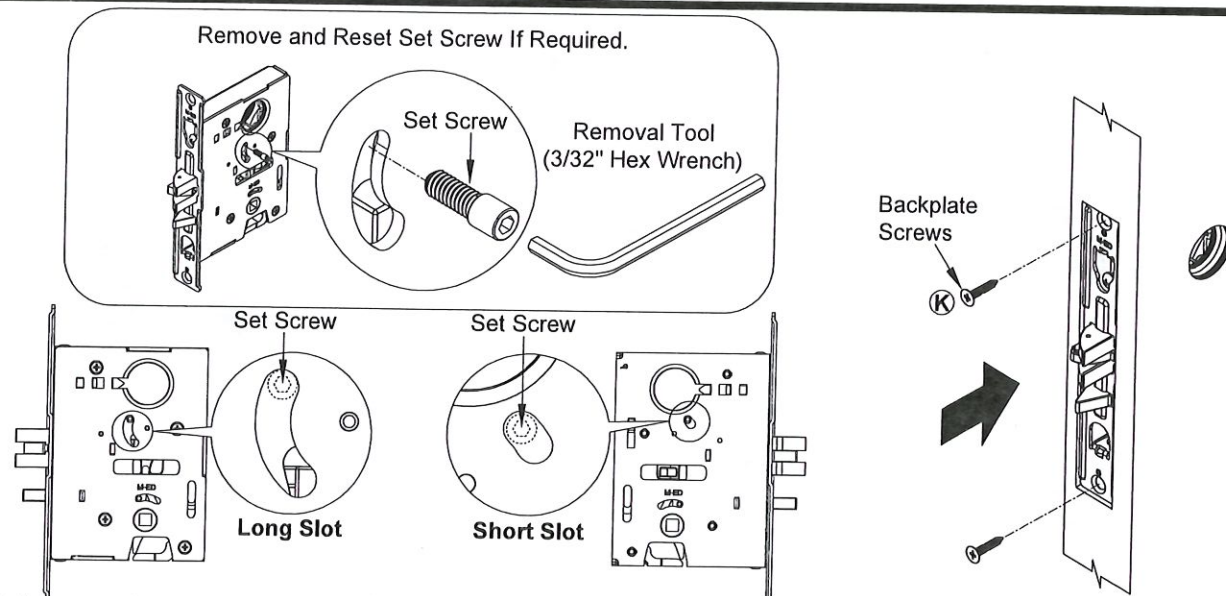

4A. Leave set screw as shipped for EO, DT and NL applications. Set screw is factory set in the long slot on one side of the mortise case.

Remove set screw and reset in short slot of the other side for TP, K, "double cylinder" and L trims with outside cylinder to lock and unlock trim function.

4B. Install mortise lock into door and fasten with backplate screws.

NOTE: Security indicator uses special mortise lock case and is already factory pre-set and does not require any modification, therefore above step is not applicable for such case.

5 INSTALL TRIM (IF USING) AND SECURE DEVICE CENTER CASE TO DOOR.

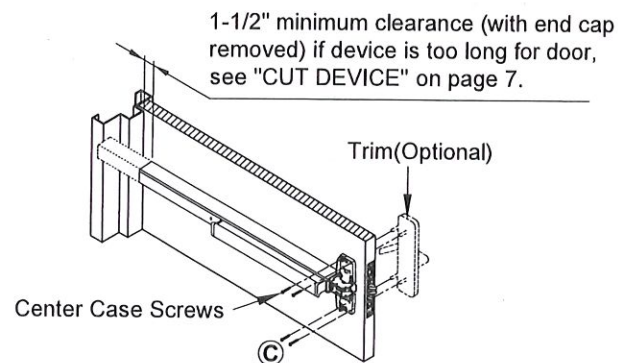

1. DEVICE WITH TRIM - See "Trim Instructions".
2. EXIT ONLY - With device adjustment finger in the mortise case, mount center case to the door with four(4) screws.
For FIRE EXIT DEVICES

Sex bolts and support screws are required for composite (wood, plastic and steel covered), wood core, sheet metal and hollow metal doors without reinforcement unless door manufacturer has an alternate mounting method. Fire doors with steel reinforcement, mount devices with machine screws

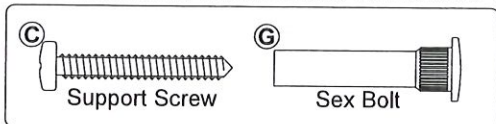

6 INSTALL OUTSIDE LOCKING CYLINDER (IF USING) AND FINISH INSTALLING MORTISE LOCK.

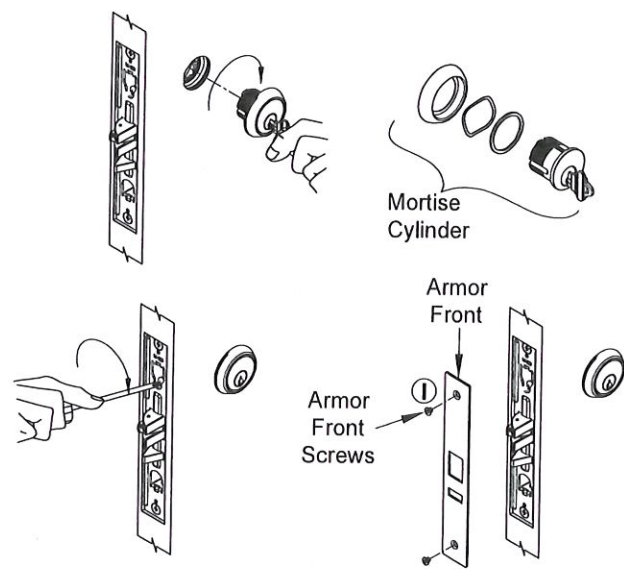

CYLINDER ONLY - Install mortise cylinder into mortise lock as shown. Check key operation and secure cylinder in place by tightening cylinder anchor screw into groove on side of cylinder.
NOTE: See "DOUBLE CYLINDER INSTALLATION" on page 7 for double cylinder application.

7 INSTALL SUPPLIED STRIKE TO FRAME OR OTHER DOOR.

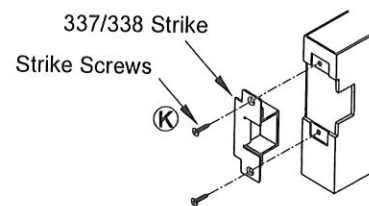
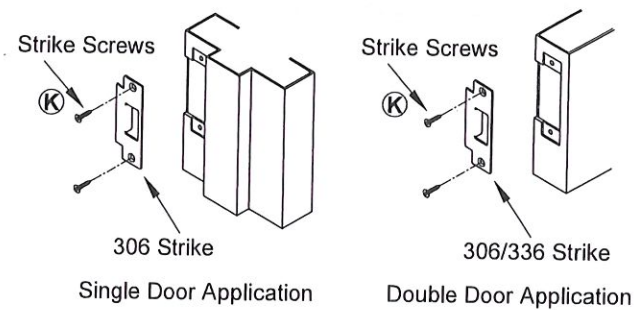

Open Back Strike For Double Door Application

See "STRIKE PREPARATION" on page 3 for preparation information.

8 INSTALL MOUNTING BRACKET AND END CAP.

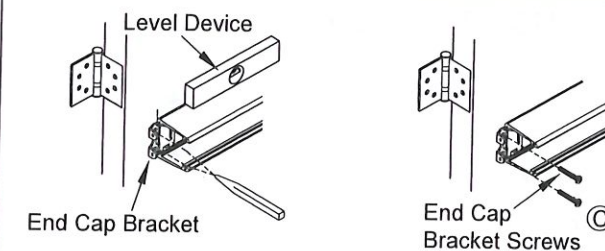

1. Remove cover plate, insert end cap bracket into push bar assembly against mechanism case. Level device, mark and drill two(2) holes for Bracket Screws. Fasten end cap bracket screws to door.

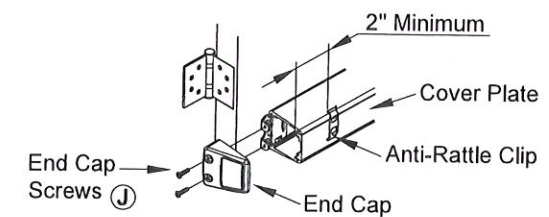

2. Insert cover plate, slide anti-rattle clip in position (2" minimum from end), and attach end cap with two(2) end cap screws.

1400 SERIES MORTISE LOCK FOR EXIT DEVICE INSTALLATION INSTRUCTIONS

1. Prepare door for device and trim (see their instructions).
2. Prepare door for mortise lock and cylinder (see preparation on other side of these instructions).
3. Change lock handing if required:
 - (a) Loose latch bar screw to project latchbolt away from mortise case.
 - (b) After latchbolt fully projected, rotate it 180° so flat side faces exit direction, tighten latch bar screw.

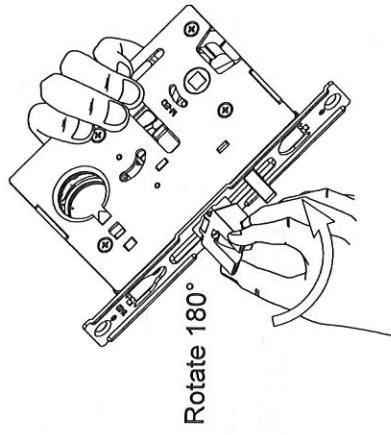
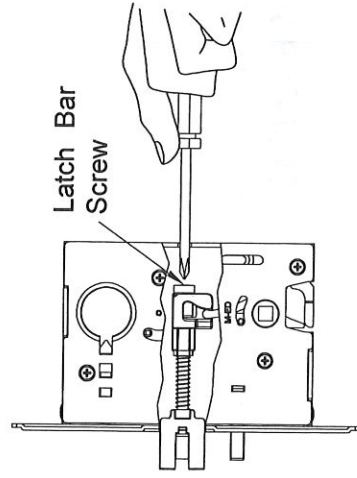

Remove and Reset Set Screw If Required.

- 4A. Remain set screw as shipped. Set screw is factory set at long slot side for EO,DT, and NL applications.

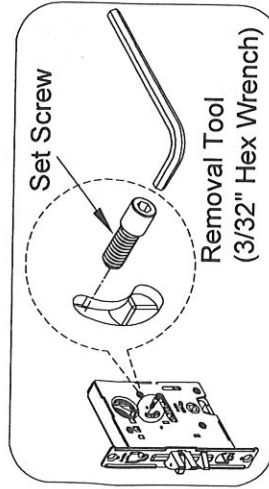

- 4B. Install mortise lock into door and fasten with backplate screws.

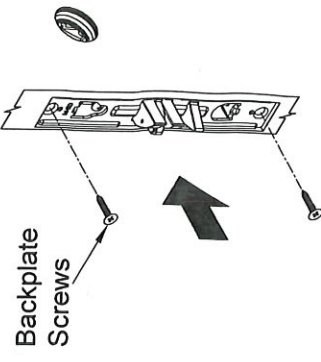
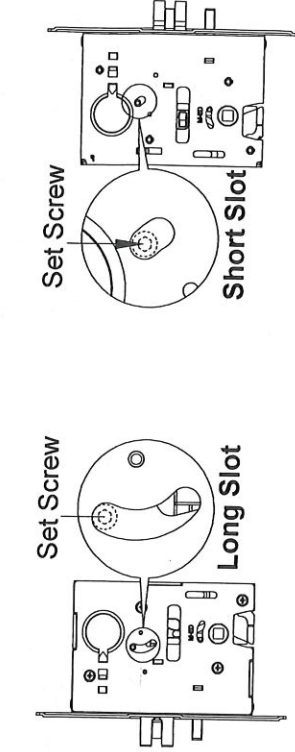

NOTE: Security indicator uses special mortise lock case and is already factory pre-set and does not require any modification, therefore above step is not applicable for such case.

5. Install trim, if using (see "Trim Instructions").

6. If using outside cylinder.

- (a) Loose cylinder anchor screw sufficiently to allow cylinder to be threaded into lock case.
- (b) Screw cylinder into the lock case, keyway must end up on bottom of cylinder housing.
- (c) Secure cylinder by tightening cylinder anchor screw into groove on side of cylinder.

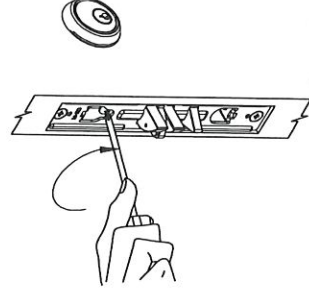
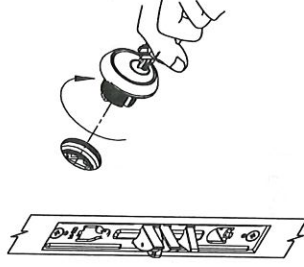
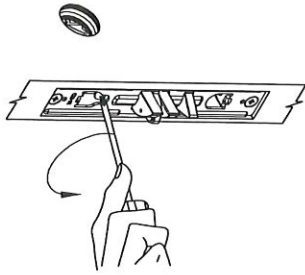

7. Finish installing mortise lock:
 - (a) Tighten two(2) backplate screws.
 - (b) Place armor front in position and install two(2) armor front screws.

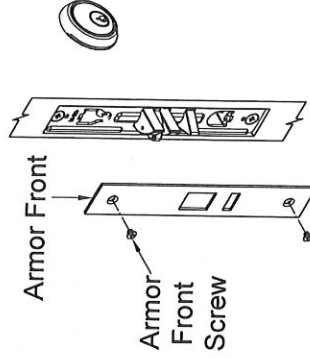
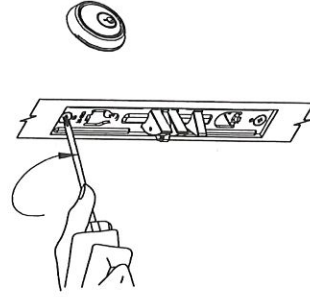

DOOR PREPARATION FOR MORTISE CYLINDER

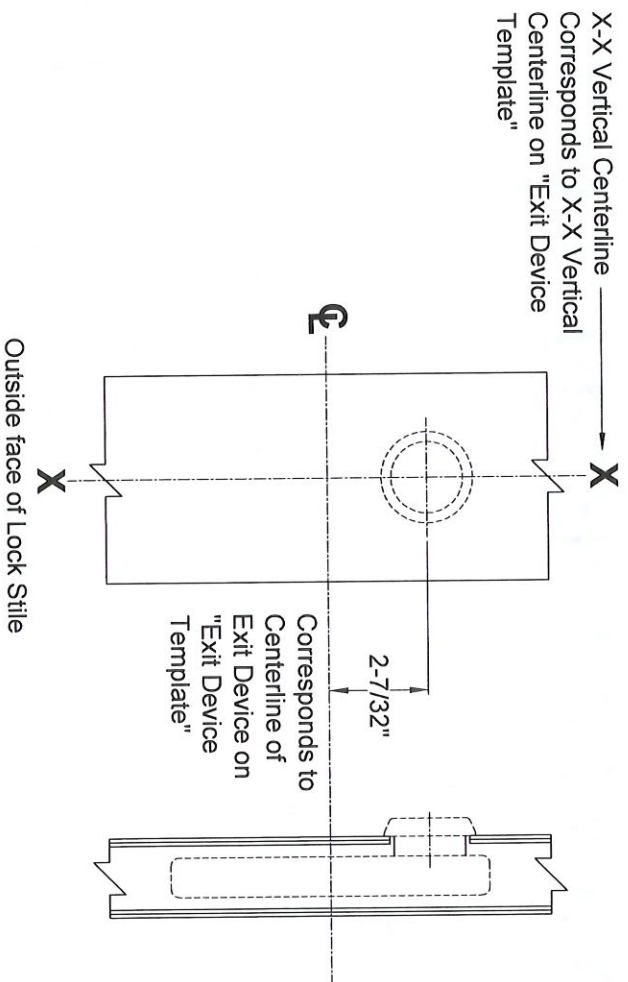

METAL DOOR PREPARATION FOR MORTISE LOCK

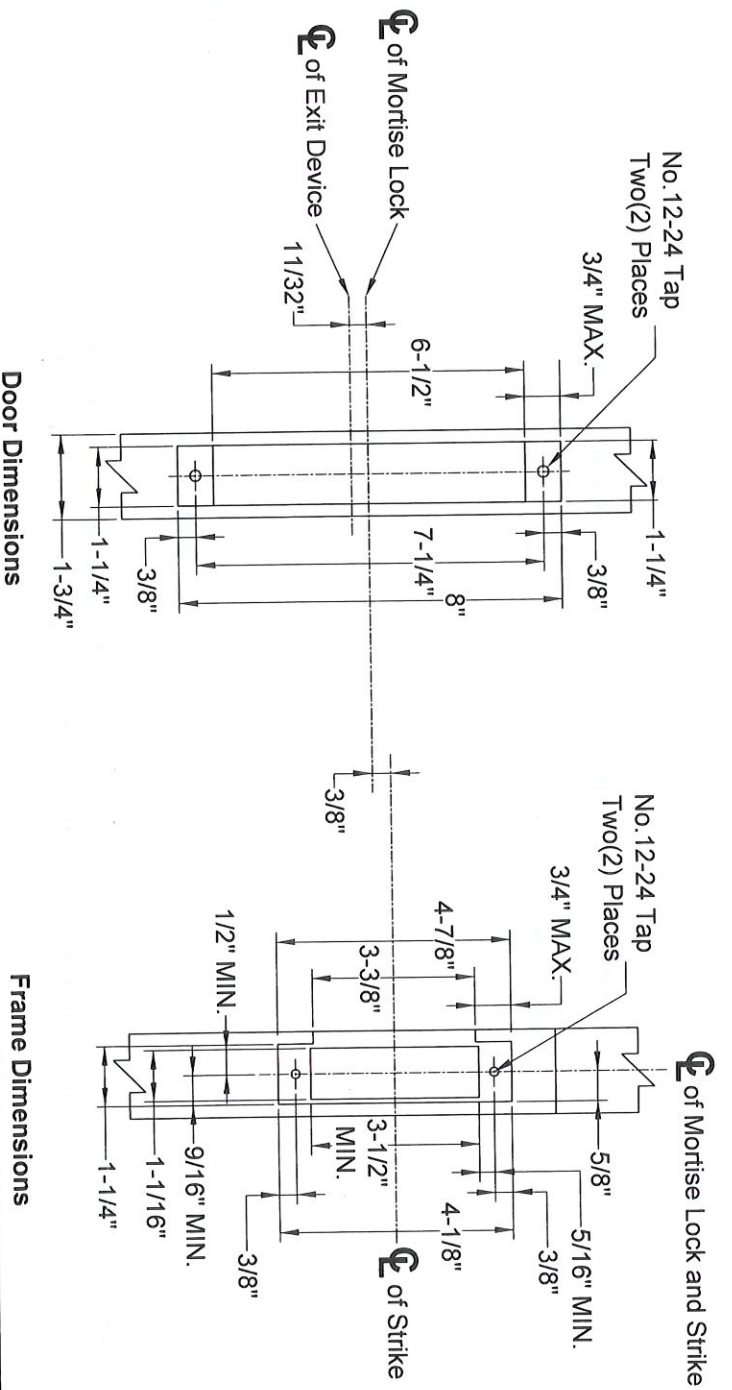

WOOD DOOR PREPARATION FOR MORTISE LOCK

