

MLR TRIM INSTALLATION INSTRUCTIONS

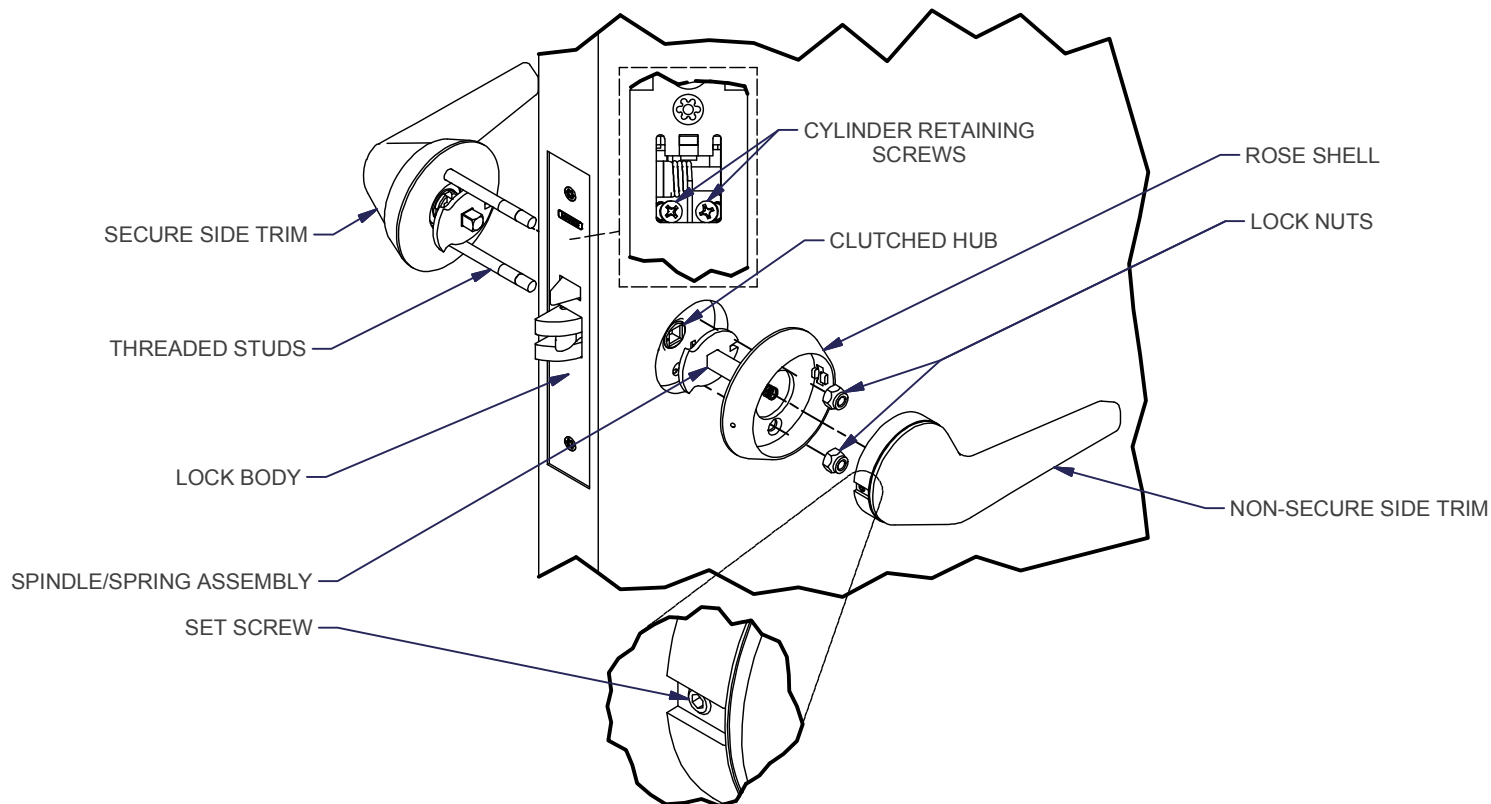

1. Install lock body in door using 2 supplied mounting screws.
2. Mount cylinder(s) (if applicable), tighten cylinder retaining screw(s) inside lock body and install face plate using 2 supplied mounting screws.
3. Install secure side trim assembly, passing threaded studs through holes in lock body. Ensure spindle engages clutched hub.

NOTE- Ensure marking on clutched hub is on horizontal centerline (3 or 9 o'clock depending on side of door).

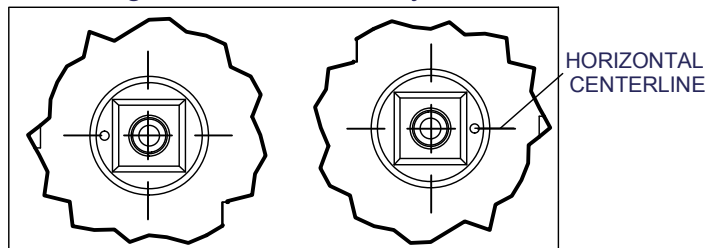

4. Slide non-secure side rose shell over threaded posts and secure using 2 supplied lock nuts.
5. Insert non-secure side spindle/spring assembly through rose shell, engaging clutched hub (marking must be on horizontal centerline).
6. Install non-secure side trim. Insert lever/rose assembly into rose shell. Insert allen wrench into hole on each side of rose shell and rotate both set screws fully counter-clockwise to secure trim to rose shell.
7. Check lock for proper operation before closing door.

