

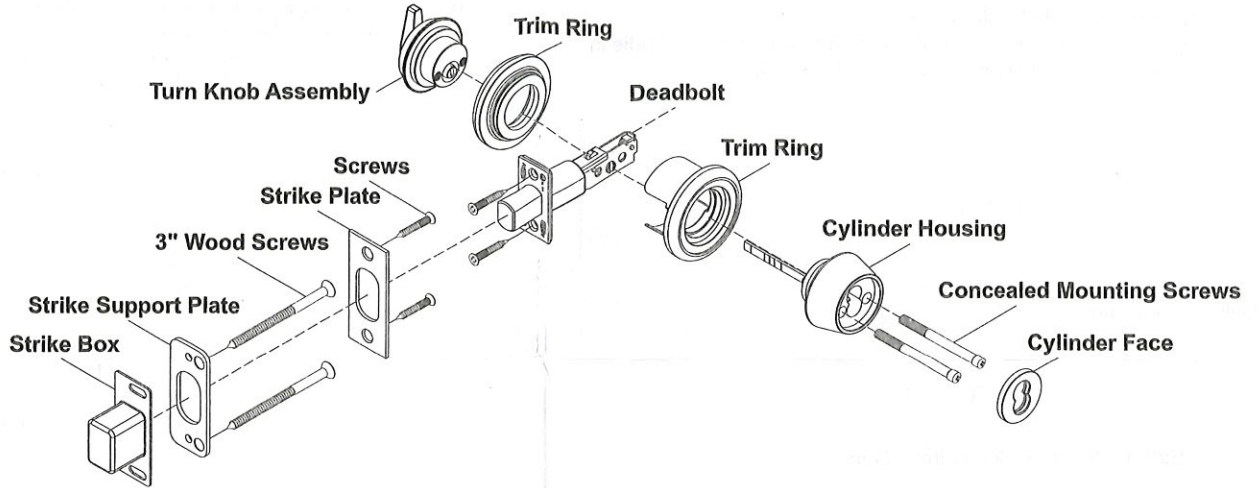

Installation Instructions for T6 Series Deadbolt (I/C)



1. Center Punch the Drill Points

- Place the template at the desired height, on the high side of the door bevel.
- Tape the template to the door.
- Center punch the drill points.

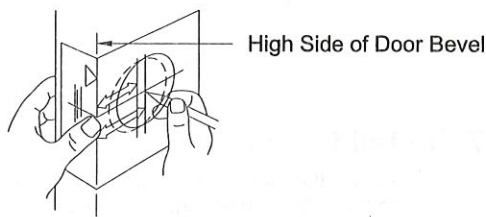

Figure 1

2. Bore Two Holes

- Bore a 2 1/8" diameter hole. To avoid splintering a wood door, bore the hole from both sides of the door.
- Drill a 1" diameter hole from the edge of the door that intersects the 2 1/8" hole.
- Using the deadbolt faceplate as a guide, mortise the edge of the door to recess the faceplate.

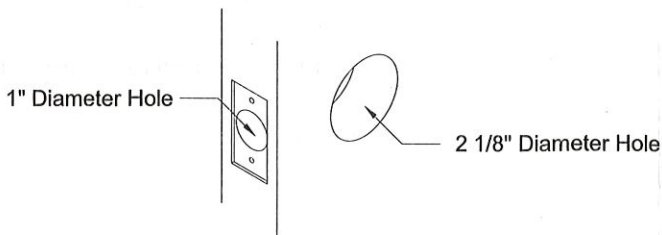

Figure 2

3. Install Strike Plate

- Center punch the jamb directly opposite the bolt hole in the door.
- Drill two 1" diameter holes, located 5/16" above and below the center punch to a depth of 1 1/8". See Figure 3.

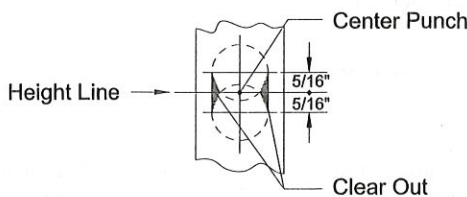

Figure 3

- Using the strike as a guide, mortise the jamb, then install the strike box, strike support plate, and strike plate with screws. See Figure 4.

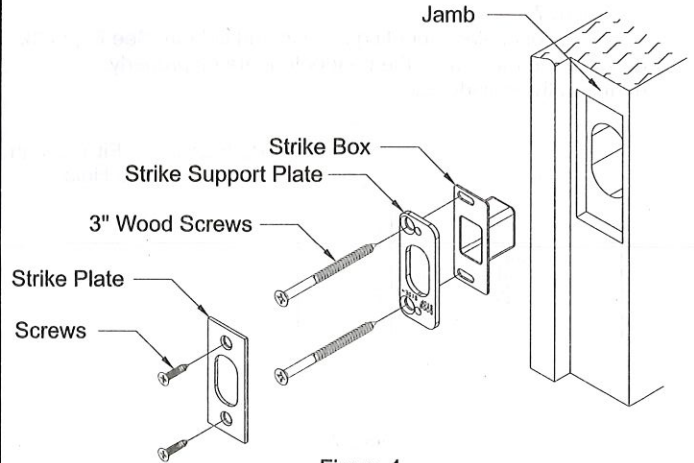

Figure 4

4. Install Deadbolt Assembly

- Insert the deadbolt with slotted spindle hole at the bottom of the assembly. See Figure 5.
- Secure the deadbolt to the door with screws.

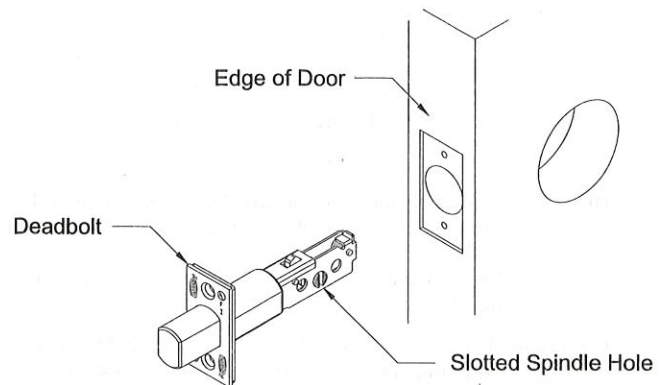

Figure 5

5. Install Cylinder or Cylinders

For Single-Keyed Cylinder Deadbolts:

- Extend the bolt with a screwdriver.
- Install the cylinder housing and trim ring with the spindle in the vertical position as shown in Figure 6.

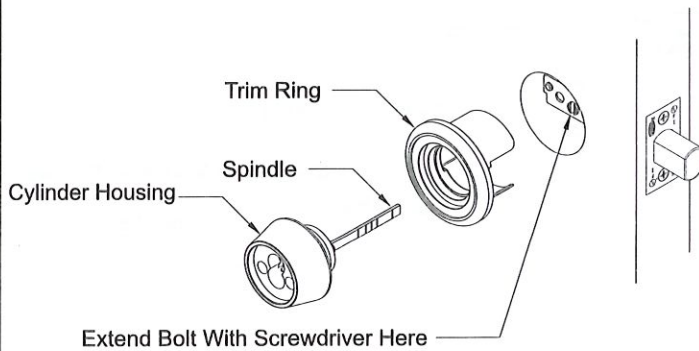

Figure 6

For Double-Keyed Cylinder Deadbolts:

- Extend the bolt with a screwdriver.
- Install each cylinder with its ring and rose as shown in Figure 7.
- Insert concealed mounting screws and tighten. See Figure 8.
- Check to make sure the deadbolt operates properly.
- Insert the cylinder face.

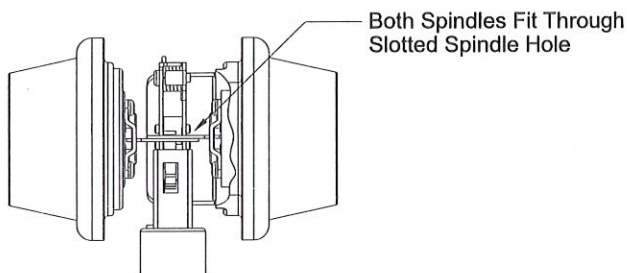

Figure 7

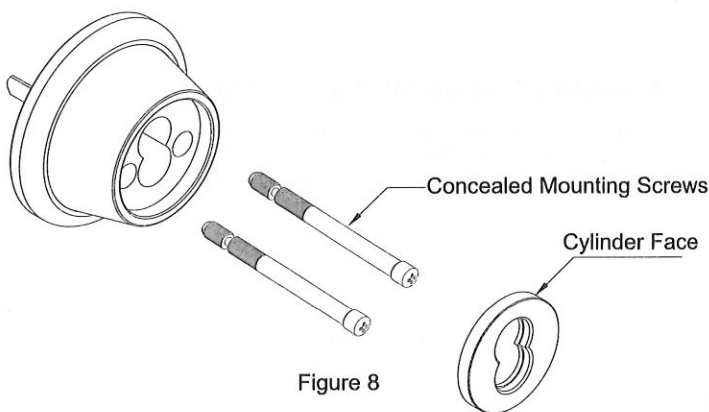

Figure 8

NOTE : 1. When possible, mount cylinders on the door so that the concealed mounting screws enter from the inside of the door.

- Both spindles must fit through the spindle hole in the deadbolt assembly.

CAUTION : Double cylinder locks are operated by key only and may hinder emergency exit . Check for applicable fire codes and / or life safety codes before installing double cylinder deadbolt .

6. Attach Inside Trim

- With the spindle in the vertical position, slide the turn knob assembly and trim ring over the spindle as shown in Figure 9.
- Secure the turn knob assembly and the cylinder to the door with the concealed mounting screws supplied as shown in Figure 10. (Cut screws for door thickness less than 2")
- Check to make sure that the deadbolt operates properly.

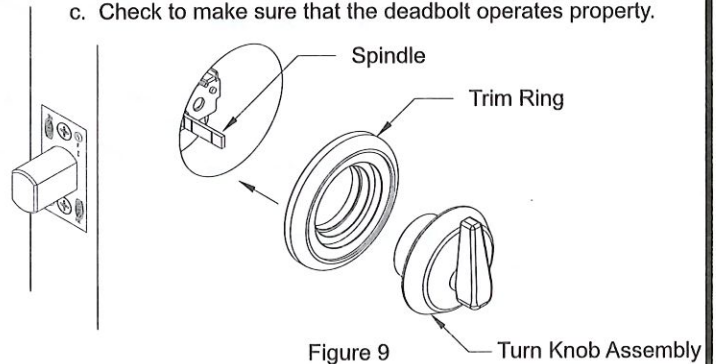

Figure 9

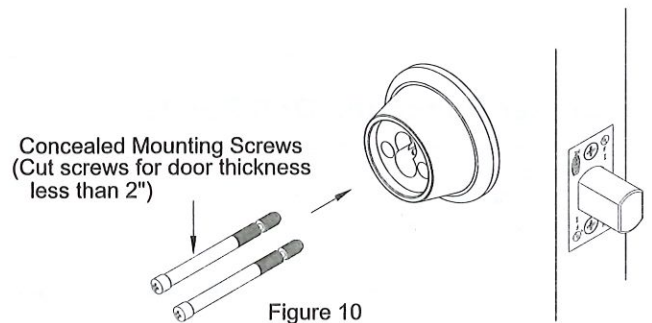

Figure 10

7. Install Core or Cores

- To cover the mounting screw holes, put the cylinder face into the cylinder housing. See Figure 11.
- Put the control key into the core and turn the key **15° clockwise(CW)**. See Figure 12.
- Adjust the throw pins if needed, then put the core into the cylinder with the control key.
- Turn the key **15° counterclockwise(CCW)** and remove the key.

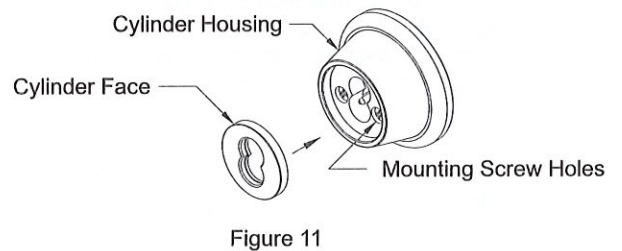

Figure 11

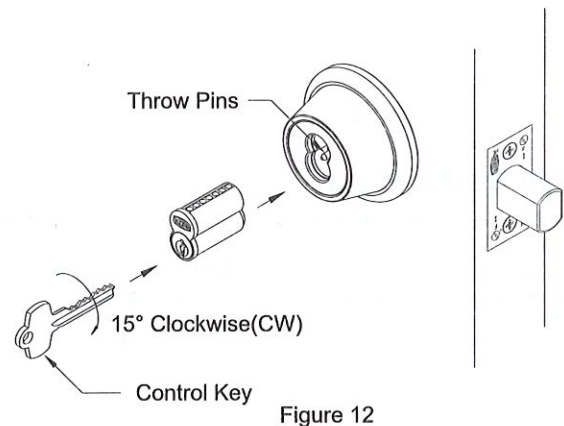

Figure 12

Patents :
Products are protected by one or more of the following U.S. patents : 5713231, 5906125, 5970760. Other patents pending.