

HOW TO INSTALL THIS HEAVY DUTY CYLINDRICAL LOCK SET

1 MARK DOOR

Mark height line (center line of latchbolt) on edge of door. Suggested height from floor 38". Mark center point of door thickness. Position center line of template on height line. Hold in place and mark center point for $2\frac{1}{8}$ " hole.

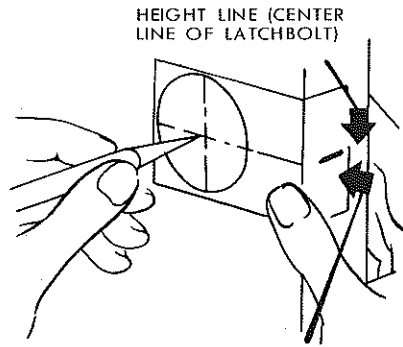

MARK CENTER FOR 1" HOLE AT CENTER POINT ON HEIGHT LINE

2 BORE TWO HOLES

Bore a $2\frac{1}{8}$ " hole at point marked through template. Bore a 1" hole straight into edge of door at center point on height line. Cut out for latch front and install latchbolt.

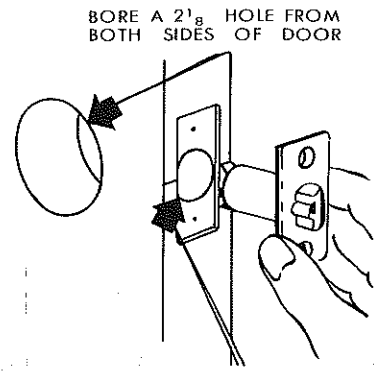

BORE A 1" HOLE AND CUT OUT FOR LATCH FRONT.

3 INSTALL STRIKE

Mark vertical line and height line on jamb exactly opposite center point of latch hole. Bore two 1" holes $11/16$ " deep in jamb on vertical line $5/16$ " above and below height line. Clean out hole and install strike.

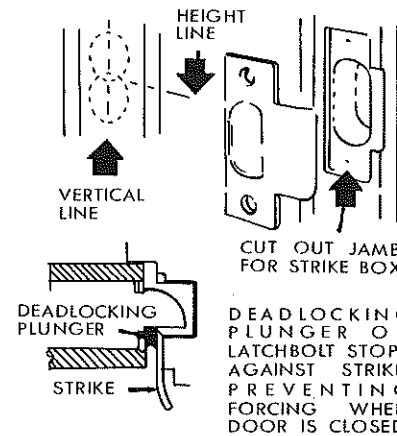

DEADLOCKING PLUNGER ON LATCHBOLT STOPS AGAINST STRIKE PREVENTING FORCING WHEN DOOR IS CLOSED.

4 REMOVE INSIDE TRIM

Insert pointed end of spanner wrench through hole in knob sleeve on side facing latch retractor. Depress knob catch and slide knob off spindle.

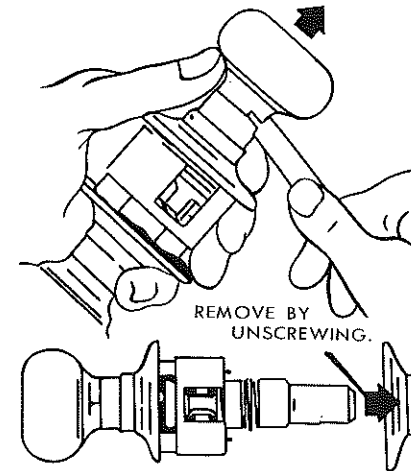

REMOVE BY UNSCREWING.

FOR REMOVING BALL KNOB

Insert pointed end of release pin (included in package) in the hole under knob sleeve on side facing latch retractor. Depress knob catch and slide knob off spindle.

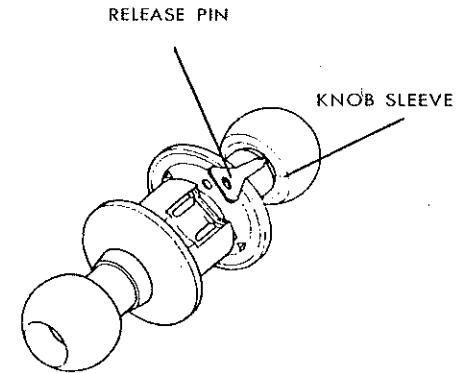

5 ADJUST ROSE

Adjust lock to fit door thickness by rotating outside rose until correct door thickness appears above edge of housing and it is engaged with ratchet.

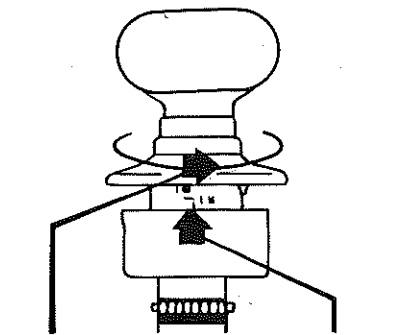

ROTATE ROSE TO ADJUST FOR DOOR THICKNESS
LOCK FITS ALL DOORS $1\frac{3}{8}$ " TO 2"

6 INTERLOCK UNITS

Latch unit must be in place before installing lock. Engage lock housing with latch prongs and lock retractor with latch bar.

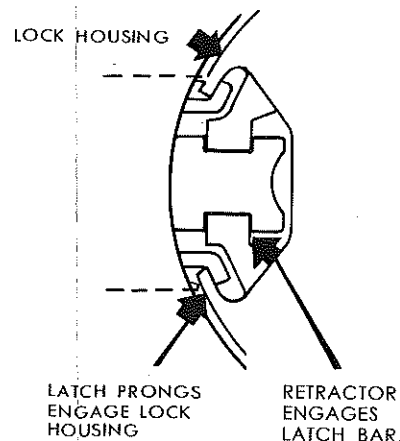

LATCH PRONGS ENGAGE LOCK HOUSING
RETRACTOR ENGAGES LATCH BAR.

7 ATTACH TRIM

Slip inside rose over spindle and screw on to threads. Tighten firmly with spanner wrench.

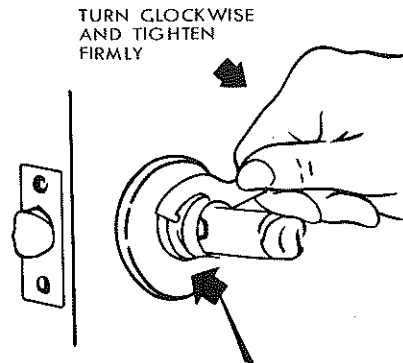

ROSE HELD STATIONARY BY ANCHOR PINS AS BUSHING IS SCREWED ON TO HUB.

8 REPLACE KNOB

Slide knob on spindle. Depress knob catch and push knob into position. Pull knob to test fastening of catch. When properly installed, both knobs should operate freely.

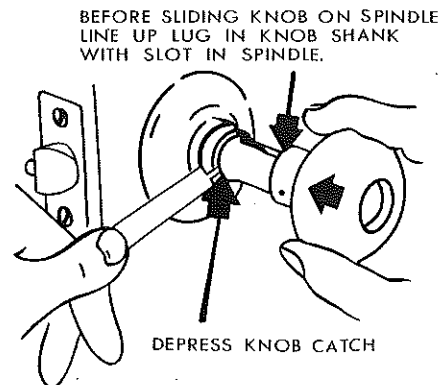

BEFORE SLIDING KNOB ON SPINDLE LINE UP LUG IN KNOB SHANK WITH SLOT IN SPINDLE.

DEPRESS KNOB CATCH

TO CHANGE LOCK HAND

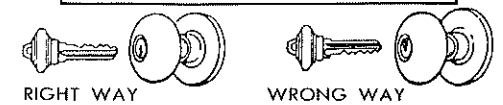

RIGHT WAY

WRONG WAY

Insert pointed end of Spanner Wrench through hole in the outside knob sleeve on side facing latchbolt. Push Spanner Wrench and at the same time turn key slowly until knob catch depresses; then pull off knob. Turn knob over and with key partly removed from cylinder, replace knob and side onto spindle up to knob catch. Turn key one-quarter turn to right, depress knob catch, and push knob into position.

