

# Installation Instructions

## 721DW

### Typical Installation

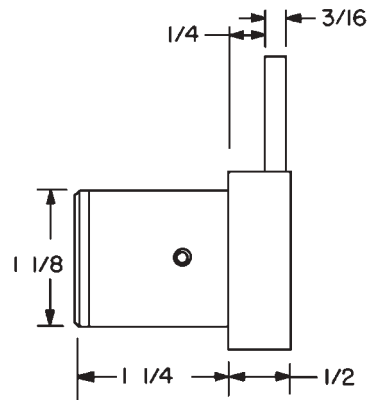
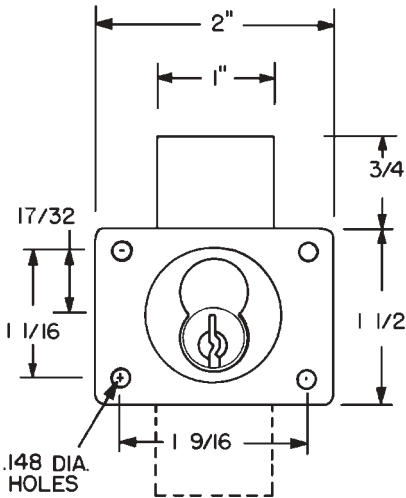
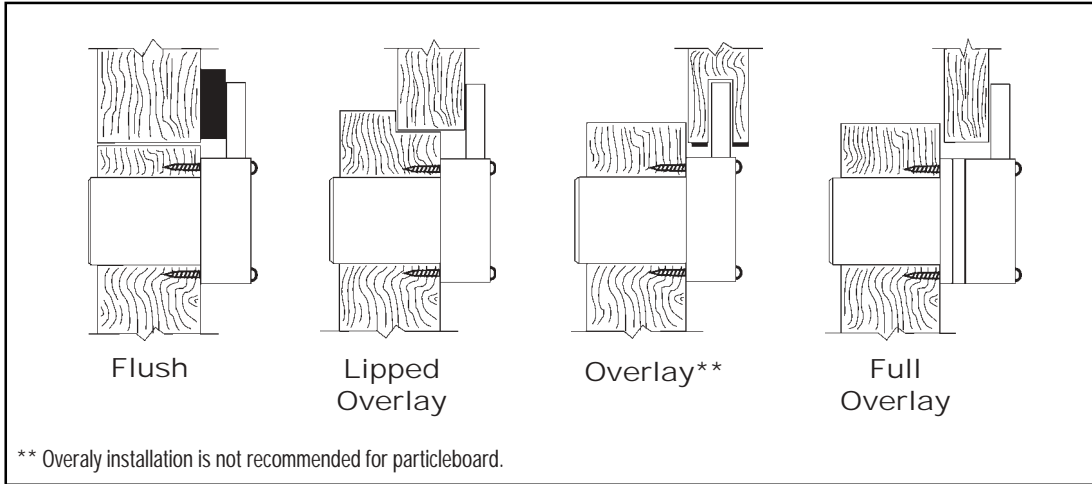

Use of spacers and strikes depends on application and material thickness.

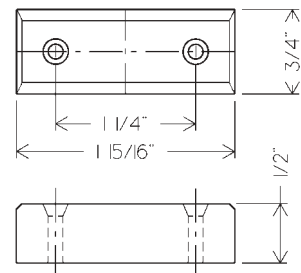

10-055 - 1/2" bar strike

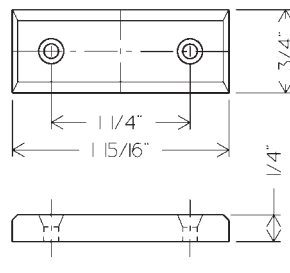

10-054 - 1/4" bar strike

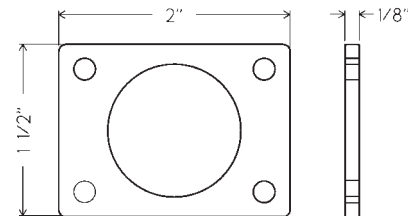

10-350 - 1/8" spacer

Title Installation instructions for 721DW series cabinet lock				
Series 721DW	Barrel Length 1-1/4"	Bolt type Deadbolt	Mounting Surface	Revision Date 06/2004

